

SHP-DP710

Samsung SDS Door Lock

User and Reference Guide

Ver1.0.0

『This manual was prepared for the certification test.』

■ Product Specifications

Item		365Plus
Size	Exterior Unit	85mm(W)×346.5mm(H)×61mm(D)
	Interior Unit	86mm(W)×354.8mm(H)×63mm(D)
Voltage		4 AA Alkaline 1.5V Batteries (LR6) (6V)
Emergency Power Source		9V Battery(6LF22) (Separately sold)
Battery Life		10 Months (based on an average of 6 uses per day)
Support Card Standard		ISO14443A (Mifare®)

■ Exterior Parts

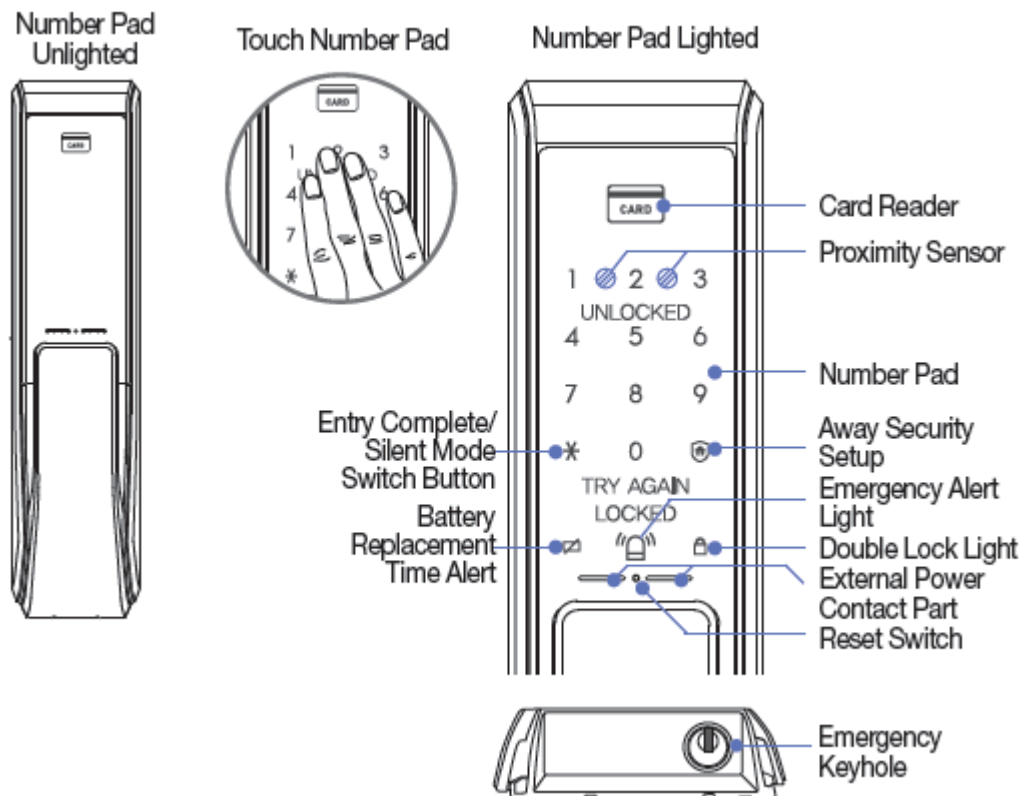

■ Interior Parts

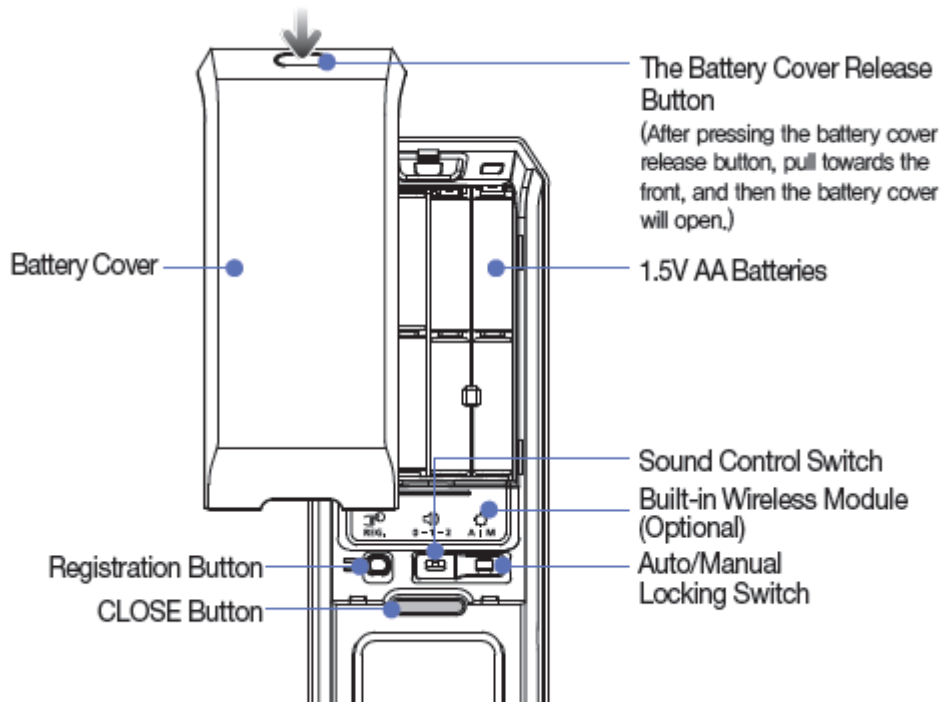

■ Mortise

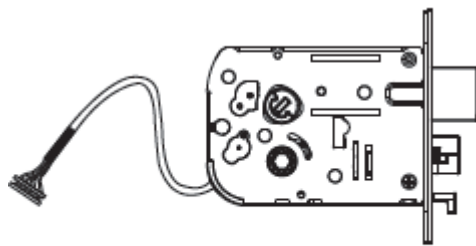

SHS-AML220

The Samsung SDS Z-Wave Door Lock is a security enabled Z-Wave Plus product that is able to use encrypted Z-Wave Plus messages to communicate to other security enable Z-Wave Plus products.

The Samsung SDS Z-Wave Door Lock must be used in conjunction with a Security Enabled Z-Wave Controller in other to fully utilize all implemented functions.

The Samsung SDS Z-Wave Door Lock can be included and operated in any Z-Wave network with otheer Z-Wave certified devices from other manufacturers and/or other applications.

Z-Wave Specifications

- Device Type : Door Lock – Keypad (SPECIFIC_TYPE_SECURE_KEYPAD_DOOR_LOCK)
- Role Type : LSS (Listening Sleeping Slave)
- Command Class Support/Control

Mandatory CC support :

- Z-Wave plus info (MUST be place first in NIF) – (V2)
- Manufacturer Specific (V2)
- Security (V1)
- Device Reset Locally (V1)
- Battery (V1)
- Power Level (V1)
- Version (V2)
- Door Lock (V2)
- User Code (V1)
- Association (V2)
- Association Group Information (V1)

Recommended CC support

- Notification (V4)
- Configuration (V1)
- Firmware update meta data (V2)
- [Schedule Entry Lock \(V3\)](#)
- Time Parameters (V1)
- Time (V2)

- Z-Wave plus info (V2)
 - Z-Wave Plus Version : 02
 - Role Type : LSS (Listening Sleeping Slave)
 - Node Type : Z-Wave Plus Node
- Manufacturer Specific (V2)
 - Device ID Type : 01 (Serial Number)
 - Device ID Data Format : 01 (Binary)
 - Device ID Data Length Indicator : 16
 - Device ID : XX XX XX XX XX XX XX XX XX XX XX XX XX XX XX XX XX
- Version (V2)
 - Z-Wave Protocol Library Type : 03
 - Z-Wave Protocol Version : 04
 - Z-Wave Protocol Sub Version : 05
 - Firmware 0 Version : 01
 - Firmware 0 Sub Version : 00
 - Hardware Version : 01
- Door Lock (V2)
 - support Unsecure(0x00), Secure(0xFF)

Note : When using 'Operation_Set' command, lock will execute 'Unsecure(0x00)' then perform 'Auto Re-lock' if door is not open.

When using 'Operation_Get' command, lock can response after executing 'Operation_Set' command. (take about 2 seconds)
- User Code (V1)
 - Lock will accept maximum 20 pin codes that are 4-10 digits in length.
- Association (V2) & Association Group Information (V1)
 - The lock supports 1 association group with 5 devices.
 - Notification Reports are sent out unsolicited to devices included in the association group.
 - Refer to Notification Table.
- Notification (V4)

Notification Type	Event	Event Parameter
Access Control (0x06)	Manual Lock Operation (0x01)	
	Manual Unlock Operation (0x02)	
	RF Lock Operation (0x03)	
	RF Unlock Operation (0x04)	
	Keypad Unlock Operation (0x06)	User ID
	RF Not Fully Locked Operation (0x08)	
	Auto Lock Loked Operation (0x09)	
	Auto Lock Not Fully Operation (0x0A)	
	Lock Jammed (0x0B)	
	All user codes deleted (0x0C)	
	Single user code deleted (0x0D)	
	New user code added (0x0E)	
	New user code not added due to duplicate code (0x0F)	
New Program code Entered - Unique code for lock configuration (0x12)		
Home Security (0x07)	Intrusion, Unkown Location (0x02)	
	Tampering, Invalid Code (0x04)	
	Motion Detection, Unknown Location (0x08)	
Emergency (0x0A)	Contact Police (0x01)	
	Contact Fire Service (0x02)	

- Configuration (V1)

Name	Parameter Number	Size	Value	Description
Security Function	0x01	1byte	0x00	Disable (Default)
			0x01	Enable
			0x02	System Disable ¹⁾
			0x03	System Enable ¹⁾
			0x04	Request for Enable ¹⁾
Privacy Mode	0x02	1byte	0x00	Disable (Default)
			0x01	Enable
Registered User ID	0x03	1byte	1 ~20	The number of registered user codes. ²⁾
Platform	0x0A	1byte	0x00	Common (Default)
			0x01	Samsung SDS

1) This value is used for Samsung SDS's platform.

2) This parameter is supported to 'Configuration Get Command' only.

- Firmware update meta data (V2)

- Manufacturer ID : 0x022E (Samsung SDS)

- Schedule Entry Lock (V3)

- Supported the Number of Slots Week Day : 0

- Supported the Number of Slots Year Day : 0

- Supported the Number of Slots Daily Repeating : 20

Glossary

Device or Node	Devices and nodes are all terms to describe an individual Z-Wave device. These are all interchangeable when setting up your Z-Wave network
Unsecure / Unsecured	Unlock / Unlocked
Secure / Secured	Lock / Locked

Inclusion	Add a Z-Wave device to the network
Exclusion	Delete a Z-Wave device from the network
Z-Wave Network	A collection of Z-Wave devices is controlled by primary and secondary controllers operating on the same system. A Z-Wave network has its own unique ID code so that controllers not in the network cannot control the system.
Association	Association is used to organize nodes in different groups allowing the device to identify the nodes by a group identifier. The groups can also be copied to other devices.

Note : Pressing the [REG] button is only available while the door is open. (Deadbolt must be unsecured.)

■ Basic Functions

1. Factory Reset

All registered Master/User data will be deleted, and Master PIN Code is set to '1234'. Also Z-Wave Door Lock is being removed from a network.

Please use this procedure only in the event that the network primary controller is missing or otherwise inoperable.

- ① Press the [REG] button for 3 seconds. (Ding dong -> Ding ding)
- ② Press the [*] button after pressing the [4560852580] button. (Ding dong dang)

2. Changing the Master PIN Code

You can enter only one Master PIN Code. If changing the Master PIN code, All User PIN Codes are deleted.

- ① Press the [REG] button. (Ding dong)
- ② Enter the new Master PIN Code, and press the [*] button.(4~12digits) (Ding dong dang)

3. Registering a User Card

You can register up to 20 User Card. (Supported ISO14443 A Type)

To register multiple cards, lightly place another card to the card reader within 20 seconds after registering the previous card. Also you can add card later after completing registration.

- ① Press the [REG] button. (Ding dong)
- ② Place the card to be registered on the card reader of the exterior body.(Ding dong dang)
- ③ Place the card on the card reader for the additional registration or press the [REG] button to quit.

4. Inclusion / Exclusion into(from) Z-Wave Network

4.1 Inclusion into Z-Wave Network

- ① Click [Add] icon in Z-Wave PC Controller Program.
- ② Press the [REG] button for 3 seconds. (Ding dong -> Ding ding)
- ③ Press the [*] button after pressing the [00] button. (Ding dong dang)

4.2 Exclusion from Z-Wave Network

After exclusion from Z-Wave Network, it will no longer be remotely-controlled via the controller.

- ① Click [Remove] icon in Z-Wave PC Controller Program.
- ② Press the [REG] button for 3 seconds. (Ding dong -> Ding ding)
- ③ Press the [*] button after pressing the [00] button. (Ding dong dang)

5. Opening the Door with a PIN Code

- ① Touch the [Touchscreen].
- ② Enter the PIN Code and press the [*] button.
- ③ The door opens within one second.

6. Opening the Door with a Card

- ④ Place the Card on the Card Reader.
- ⑤ The door opens within one second.

■ Additional Function

7. Privacy Mode Function

Press and hold the [CLOSE] button for more than three seconds. (Ding dong dang)

As it is set from the inside, provides a secure lock for the convenience of the occupant(s). When the privacy mode function is activated, the door cannot be unlocked(unsecured) from the outside, so please be careful.

8. Setting the Security Function

This is a function to prevent any intrusion while you are out. Should the door be opened from the inside while the intrusion prevention function is on, the emergency alert light will flash and the alarm will make “beep beep beep~” sound.

- ① When the door is closed [] of the exterior body's number pad will light up.

- ② Press the [] button on the exterior body within 3 seconds while the door is locked.
(Ding dong dang)

9. Lockout Mode

When more than 5 failed authentication attempts with unregistered PIN Code/Cards occur, the alarm sound is generated, and the lock is deactivated for 3 minutes.

10. Intrusion Detection Function

When the Interior Unit is forcibly detached while the door is locked, it is detected by the door open/close sensor, the alarm sounds. The Intrusion Detection function is a basic function and cannot be disabled.

11. Sound Setting

The sound that is generated when the number buttons are pressed, when the door is locked or when the locked door is unlocked, can be set according to the user's preference.

Put the [Sound Control] switch on one of [0], [1] or [2].

[0] : Mute [1] : Normal [2] : Loud

12. Additional Function Mode

