

### Federal Communications Commission Statement

This equipment has been followed to comply with Part 15 of the FCC Rules. This equipment generates, uses and can radiate radio frequency energy and, if not installed and used in accordance with the instruction, may cause harmful interference to radio communications. However, there is no guarantee that interference will not occur in a particular installation. If this equipment does cause harmful interference to radio or television reception, which can be determined by turning the equipment off and on, the user is encouraged to try and correct the interference by one of the following measures:

- Reorient or relocate the receiving antenna,
- Increase the separation between the equipment and receiver,
- Connect the equipment into and outlet on a circuit different from that to which the receiver is connected.

Consult the dealer or an experienced radio/TV technician for help.

This device complies with Part 15 of the FCC Rules. Operation is subject to the following two conditions: (1) this device may not cause harmful interference, and (2) this device must accept any interference received, including interference that may cause undesirable operation.

FCC Caution: Any changes or modifications not expressly approved by the party responsible for compliance could void the user's authority to operate this equipment.

### Limited Warranty

Vision Guarantees that every wireless lighting module is free from physical defects in material and workmanship under normal use for one year from the date of purchase. If the product proves defective during this one-year warranty period, Vision will replace it free of charge. Vision does not issue any refunds. This warranty is extended to the original end user purchase only and is not transferable. This warranty does not apply to: (1) damage to units caused by accident, dropping or abuse in handling, or any negligent use; (2) units which have been subject to unauthorized repair, taken apart, or otherwise modified; (3) units not used in accordance with instruction; (4) damages exceeding the cost of the product; (5) transit damage, initial installation costs, removal cost, or reinstallation cost.

For information on additional devices, please visit us at [www.visionsecurity.com.tw](http://www.visionsecurity.com.tw)



## Operation Manual

**ZL 7261 CL-5**

**ZL 7261 CN-5**

**ZL 7261 DE-5**

**ZL 7261 FR-5**

**ZL 7261 IT-5**

**ZL 7261 JP-5**

**ZL 7261 KR-5**

**ZL 7261 RU-5**

**ZL 7261 US-5**

**Z-Wave Power Monitor**

ZL7261-5	V0	1070301	
----------	----	---------	--

## Introduction

Thanks for choosing the Vision's Power Monitor of the home automation device. This Power Monitor Module is a Z-Wave™ enabled device (interoperable, two-way RF mesh networking technology) and is fully compatible with any Z-Wave™ enabled network. Every main powered Z-Wave™ enabled device acts as a signal repeater and multiple devices result in more possible transmission routes, which helps eliminate "RF dead-spot".

Z-Wave™ enabled devices displaying the Z-Wave™ logo can also be used with it regardless of the manufacturer, and ours can also be used in other manufacturer's Z-Wave™ enabled networks. It will send the energy consumption to the controller when it requests. With special design, this module won't interfere the other power outlet when plug into the AC outlet. **This module acts as repeater. When the device is secure included into Z-Wave network, above communication will be encrypted, ZD2112 supports SECURITY S0 / SECURITY S2 UNAUTHENTICATED / SECURITY S2 AUTHENTICATED.**

## Product Description and Specification

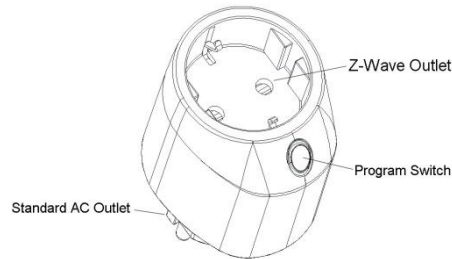

Type F: Schuko

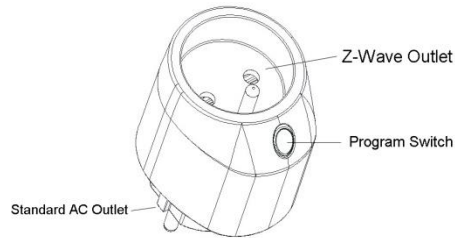

Type E: French

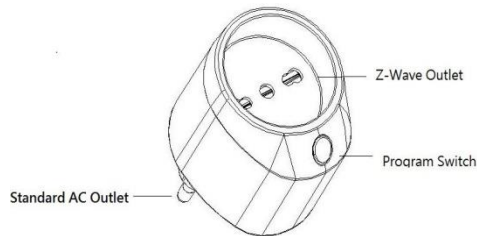

Type L: 10A

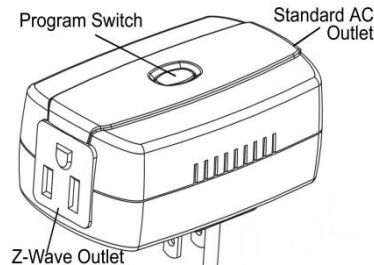

Type B

\*\*For making better effect, please press the button as the direction of following diagram.

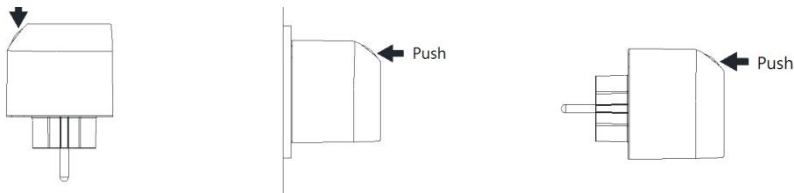

## Specification:

Protocol: Z-Wave™ (ZM5202)  
 Frequency:  
 865.22MHz (ZD2112IN-5)  
 868.10MHz (ZD2112MY-5)  
 868.42MHz (ZD2112EU-5)  
 869.00MHz (ZD2112RU-5)  
 908.42MHz (ZD2112US-5)  
 916.00MHz (ZD2112IL-5)  
 920~923MHz (ZD2112KR-5)  
 919.80MHz (ZD2112HK-5)  
 922~926MHz (ZD2112JP-5)  
 921.42MHz (ZD2112BR-5)  
 Operating Temp. -15°C~ 60°C (-5°F~ 140°F)  
 Operating Voltage: AC 100V~230V  
 Operating Range: Up to 100 feet (about 30m)  
 Data Rate: Up to 9.6k/40k/100kbps  
 Application: Indoor use  
 Max Loading  
 Type B: 110V/15A/1600W (Resistive)  
 220V15A/3200W (Resistive)  
 Type E, F & L: 230V/10A/2300W (Resistive)

## Package Content:

1pc Power Monitor f Module  
 1pc User Manual

## Z-Wave™ Command Class:

COMMAND\_CLASS\_ASSOCIATION\_GRP\_INFO  
 COMMAND\_CLASS\_ASSOCIATION\_V2  
 COMMAND\_CLASS\_CONFIGURATION  
 COMMAND\_CLASS\_DEVICE\_RESET\_LOCALLY  
 COMMAND\_CLASS\_FIRMWARE\_UPDATE\_MD\_V4  
 COMMAND\_CLASS\_MANUFACTURER\_SPECIFIC\_V2  
 COMMAND\_CLASS\_METER\_V5  
 COMMAND\_CLASS\_POWERLEVEL  
 COMMAND\_CLASS\_SECURITY  
 COMMAND\_CLASS\_SECURITY\_2  
 COMMAND\_CLASS\_SUPERVISION  
 COMMAND\_CLASS\_SWITCH\_BINARY (Mapping COMMAND\_CLASS\_BASIC\_V2)  
 COMMAND\_CLASS\_TRANSPORT\_SERVICE\_V2  
 COMMAND\_CLASS\_VERSION\_V3  
 COMMAND\_CLASS\_ZWAVEPLUS\_INFO\_V2,

## Z-Wave S2 Support Command Classes :

COMMAND\_CLASS\_ASSOCIATION\_V2  
 COMMAND\_CLASS\_ASSOCIATION\_GRP\_INFO  
 COMMAND\_CLASS\_CONFIGURATION  
 COMMAND\_CLASS\_DEVICE\_RESET\_LOCALLY  
 COMMAND\_CLASS\_FIRMWARE\_UPDATE\_MD\_V4  
 COMMAND\_CLASS\_MANUFACTURER\_SPECIFIC\_V2  
 COMMAND\_CLASS\_METER\_V5  
 COMMAND\_CLASS\_POWERLEVEL  
 COMMAND\_CLASS\_SUPERVISION  
 COMMAND\_CLASS\_SWITCH\_BINARY  
 COMMAND\_CLASS\_VERSION\_V3

## Operation

If you are installing the entire Z-Wave™ system for the first time, please refer to the installation guide of Z-Wave™ Interface Controller before installing **ZL7261**.

### 1. LED Status:

After Power On, LED will keep flashing Red & Green if ZL7261 has not been included yet.  
After Power On, LED will flash the color what power is loading if ZL7261 has been included.

#### Power Loading vs LED Color

LED Color	Plug Type E, F & L	Plug Type B
Green	0~3A	0~5A
Green+Red	3~7A	5~10A
Red	7A~	10A~

2. For **"Inclusion"** in (adding to) a network: Put the Z-Wave™ Interface Controller into "inclusion" mode, and following its instruction to add the **ZL7261** into your controller. To get in the "Inclusion" mode. By power up to get included for first time, press the Program switch **3 times within 3 seconds to be included**.

For **"Exclusion"** from (removing from) a network: Set up the Z-Wave™ Interface Controller into "exclusion" mode, and following its instruction to delete the **ZL7261** from your controller. Press the Program Switch **3 times within 3 seconds to be excluded**.

For **"Association"**: the Z-Wave™ interface controller set "Association", and following its instruction to associate the **ZL7261** with other device. Support one group (5 nodes). **ZL7261** will report back every time ON and OFF status and power consumption, also it will reports every notification to all devices in the association group.

3. For "Meter Supported Get" : the Z-Wave™ Interface Controller or Gateway can send "Meter Get" command with any of the following supported scales, and the ZL7261 will report back with the energy consumption values for the requested scale:

Scale: 0x00-kWh  
0x01-kVAh  
0x02-W (Default)  
0x04-V  
0x05-A  
0x06-Power Factor.

### 4. Power Level Control:

\* Use PowerLevel Set Command to set the RF strength during a specific period.  
\* Use PowerLevel Test Node Set Command to test the RF strength for specific node.

5. Manually turn the connected appliance On/Off by your controller or pressing the Program Switch. This is toggle switch. If the connected appliance is OFF, pressing the Program Switch turns the connected appliance ON and vice versa.
6. The on/off function uses the Z-Wave Switch Binary Command Class (or Basic Command Class) to control its operation. Sending a switch binary set command with a level of 0 (0x00) will turn off the device, and sending a level of 255 (0xFF) will turn on the device.
7. Repeater Function: This device acts as a repeater for the Z-Wave mesh network functionality.

## 8. Configuration:

	Parameter	Size	Value	Notes
Auto report timing	1	1 byte	1 ~ 120 minutess (Default 1 minute )	Report kWh/kVAh
Report when Watt change	2	2 byte	5-3600 watt for Type B plug 5~2300 watt for all other plug (Default 50 watt)	Report V.A.W

9. Support Meter Auto Report Function.
10. Overload Protection: If load is excess 15.5A for Type B plug or 10.5A for all others, then relay will automatically cut off. To restore the relay, please power off & power on the device again.
11. Support SECURITY S0, SECURITY S2 UNAUTHENTICATED & SECURITY S2 AUTHENTICATED.
12. Support SmartStart, please scan the QR Code from ZL7261 for SmartStart. **The Z-Wave SmartStart QR code is located on the body of the ZL7261DE-5 and is immediately above the text identifying the Z-Wave Pin Code. Also, the full DSK can be only found on the additional card in the package**
13. Reset: Press the Program Switch then power on (plug-in) and hold for 5 seconds before release the switch. Only use this procedure when the primary controller is lost or otherwise inoperable. (Remark: This is to be used only in the case of primary controller being inoperable or otherwise unavailable.)
14. Support OTA (Over-the Air) Firmware update from controller. Please refer to your controller manual. Once OTA function success, please make sure to exclude the device & include again before using the device.