

SAMSUNG

SM-V510

User Manual

Table of contents

Getting started

- 3 About the Galaxy Home
- 4 Read me first
- 5 Device layout
- 9 Preparation to use the speaker

Using the speaker

- 17 Using Bixby
- 26 Playing music
- 32 Using the speaker through Bluetooth

Configuring the speaker

- 33 Viewing product registration information
- 34 Bixby settings
- 35 General settings

Appendix

- 37 Troubleshooting
- 40 Managing the speaker

Getting started

About the Galaxy Home

The Galaxy Home is a speaker that provides high-quality sound optimized with Harman's premium audio technology. It supports Bixby service so you can control music playback and IoT (Internet of Things) products by voice.

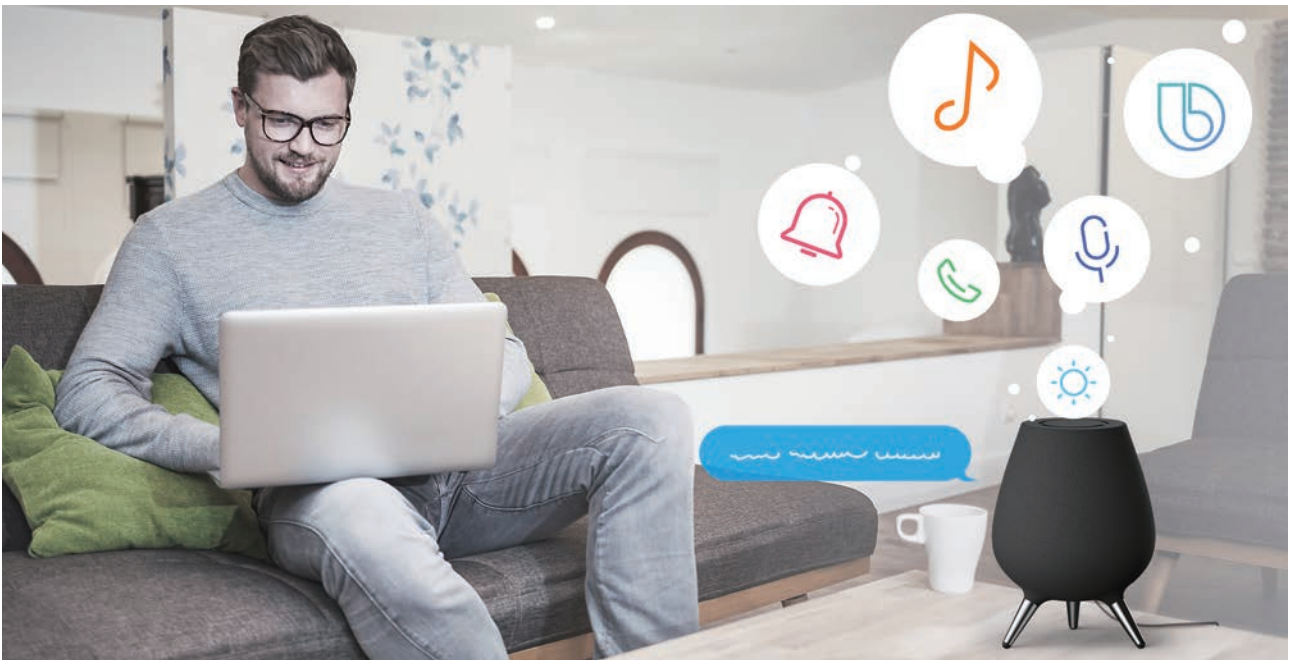

Read me first

Please read this manual before using the device to ensure safe and proper use.

- Descriptions are based on the device's default settings.
- Some content may differ from your device depending on the region, service provider, model specifications, or device's software.
- This product can be used in connection with a Wi-Fi router connected to the Internet. Prepare your Wi-Fi router and smartphone with internet connection.
- Software, sound sources, wallpapers, images, and other media provided with this device are licensed for limited use. Extracting and using these materials for commercial or other purposes is an infringement of copyright laws. Users are entirely responsible for illegal use of media.
- Default apps that come with the device are subject to updates and may no longer be supported without prior notice. If you have questions about an app provided with the device, contact a Samsung Service Center.
- Modifying the device's operating system or installing softwares from unofficial sources may result in device malfunctions and data corruption or loss. These actions are violations of your Samsung license agreement and will void your warranty.
- This product includes certain free/open source software. To see the instructions for viewing the open source license, go to the Samsung website (opensource.samsung.com).

Instructional icons



Warning: situations that could cause injury to yourself or others



Caution: situations that could cause damage to your device or other equipment



Notice: notes, usage tips, or additional information

Device layout

Package contents

Refer to the quick start guide for package contents.



- The items supplied with the speaker and any available accessories may vary depending on the region or service provider.
- The supplied items are designed only for this device and may not be compatible with other devices.
- Appearances and specifications are subject to change without prior notice.
- You can purchase additional accessories from your local Samsung retailer. Make sure they are compatible with the device before purchase.
- Use only Samsung-approved accessories. Using unapproved accessories may cause the performance problems and malfunctions that are not covered by the warranty.
- Availability of all accessories is subject to change depending entirely on manufacturing companies. For more information about available accessories, refer to the Samsung website.



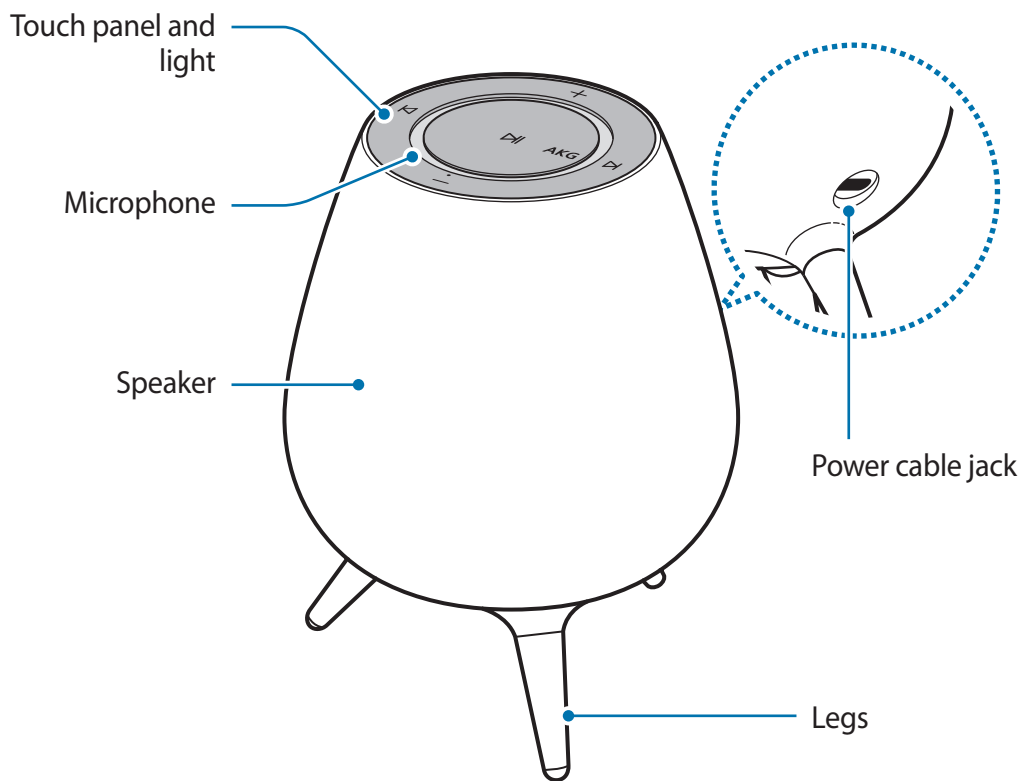

Device layout

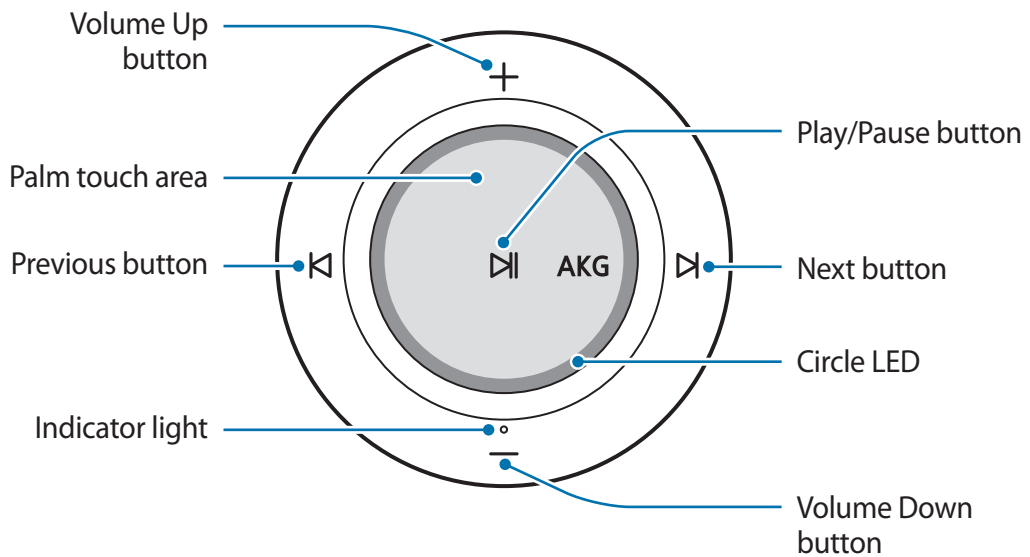

Touch panel and light

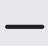

Use the touch panel when it is difficult to control the speaker by voice. The functions of the touch panel are as follows.

Touch panel	Function
 Play/Pause button	<ul style="list-style-type: none"> • Press to play or pause music. • Press and hold for 1 second to launch Bixby. (It does not work when the microphones are turned off.) • Press to turn off Bixby while it is processing your request. • Press to stop an alarm or timer. • Press to turn off the notification sound. • When a call is incoming, press to answer the call. • When you are on a call, press to end the call.
 Volume Up button	<ul style="list-style-type: none"> • Press to increase the volume. • Press and hold to increase the volume incrementally. • Press to turn off a ringtone.
 Volume Down button	<ul style="list-style-type: none"> • Press to decrease the volume. • Press and hold to decrease the volume incrementally. • Press to turn off a ringtone.
 Previous button	<ul style="list-style-type: none"> • Skip to the previous song.
 Next button	<ul style="list-style-type: none"> • Skip to the next song.
Palm touch area	<ul style="list-style-type: none"> • Turn microphones on or off.

You can view the current status of the speaker by the changes of the lighting of the speaker.

light	Function
Indicator light	<ul style="list-style-type: none"> • Blue: When booting • Red: When microphones are off • Flashing blue: When updating software, during initial setup, when set to the left speaker in stereo mode • Flashing red → green → blue: When entering Bluetooth pairing mode • Flashes blue three times: When a Bluetooth connection is established • Flashing red: Function error, no network connection, when set to the right speaker in stereo mode • Flashes red three times and turns off: When rebooting
Circle LED	<p>The circle LED alerts you to Bixby's status and notifications.</p> <ul style="list-style-type: none"> • Turns on when Bixby is listening or speaking • Turns on clockwise while Bixby is processing your request • Turns on when the alarm or timer is sounding

Preparation to use the speaker

To use the speaker, you must first connect the legs to the speaker, install it on a flat surface, and enter your Wi-Fi information and Samsung account information to the speaker. After completing the initial setup, you can use the speaker by itself without a smartphone.

1 Attaching the legs and installing the speaker

- 1 Remove the rubber cap from the bottom protruding part of the speaker.

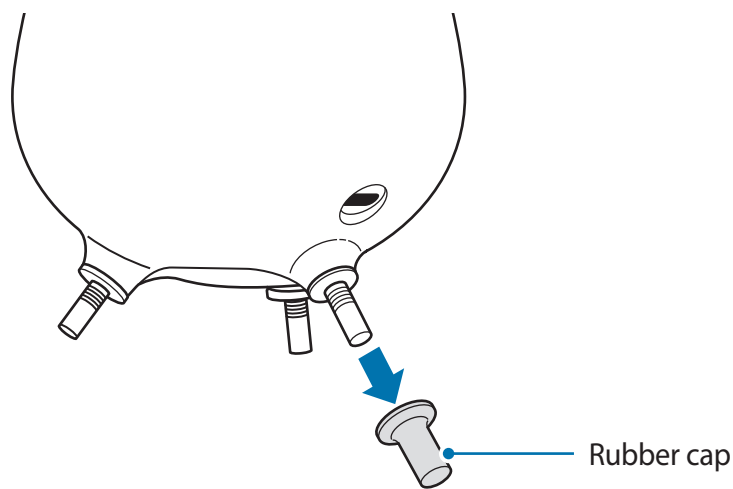

- 2 Screw in the leg to attach it.

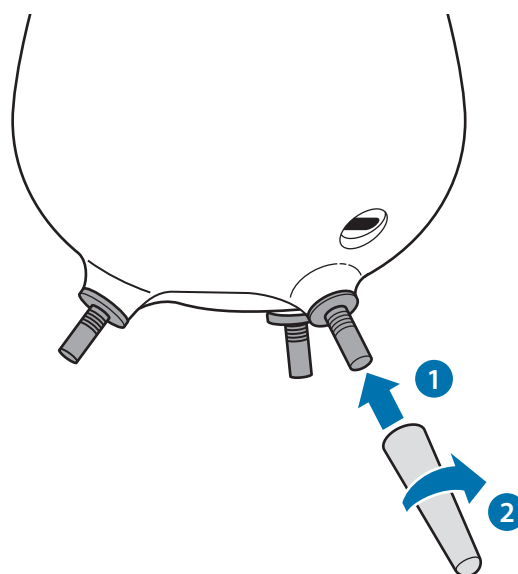

3 Place the speaker on a flat area where it will not fall down.



If you do not attach the legs to the speaker, the speaker may fall over or damage the floor.

2 Turning on the speaker

Connect the power cable to the speaker's power cable jack and into an electric socket.

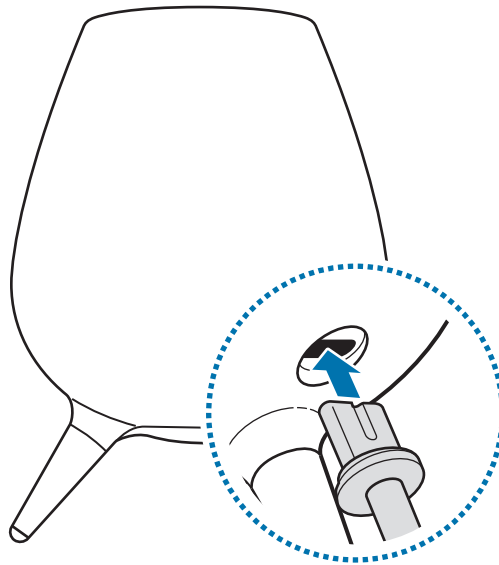

The indicator light will flash blue. It will then turn off and the circle LED will start to turn on clockwise, and the speaker will turn on.

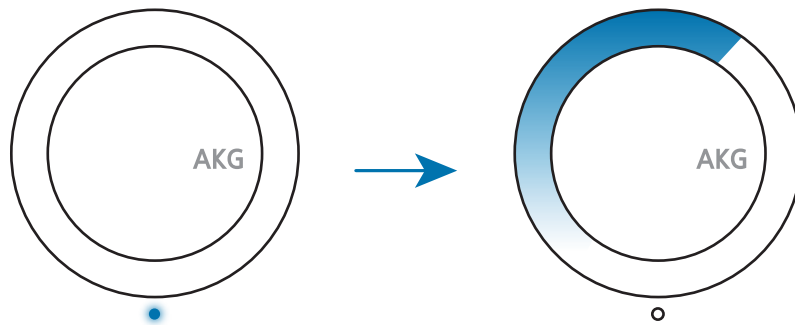

Use only Samsung-approved power cable provided with the speaker.



To save energy, unplug the power cable when not in use. The power cable does not have a power switch, so you must unplug the power cable from the electric socket when not in use to avoid wasting power. The speaker should remain close to the electric socket and easily accessible while charging.

Q I want to turn off the power.

A This speaker does not have a power button. Simply unplug the power cable from the electric socket.

3 Connecting your smartphone to Wi-Fi

You can use the speaker wherever you can connect to Wi-Fi. Before using the speaker, make sure the Wi-Fi works properly.

On your smartphone's settings screen, turn on the Wi-Fi feature and connect to Wi-Fi.



- Connect within 5 m of the Wi-Fi router.
- For secured Wi-Fi, enter the password to connect.
- You may fail to connect to Wi-Fi in the following situations:
 - When trying to connect to the Wi-Fi of a public facility, company, or dormitory which has a security policy
 - When trying to connect to a home router installed by a carrier haphazard operation
 - When trying to connect to a router on which certain ports are restricted

4 Installing the SmartThings app on your smartphone

Before using the speaker, you should install the SmartThings app on your smartphone.

Depending on your smartphone, you can download the SmartThings app from the following places:

- Samsung Android smartphones: **Galaxy Apps, Play Store**
- Other Android smartphones: **Play Store**
- iPhone: **App Store**



- To view the smartphones compatible with the **SmartThings** app, visit www.samsung.com.
- You must register and sign in to your Samsung account to use the **SmartThings** app.
- If the **SmartThings** app is not the latest version, update it.
- Supported features may vary depending on your smartphone and its operating system.
- To play music, you must register and sign in to your Spotify account.

5 Initial setup

Setup for Android smartphones

- 1 On your smartphone, launch the **SmartThings** app and move close to the speaker. A connection pop-up window will automatically appear on your smartphone.



- 2 Tap **GET STARTED** on the pop-up window.
- 3 Follow the on-screen instructions to complete the connection. When the connection is completed, the **Galaxy Home (XXXX)** card will appear on the devices list.

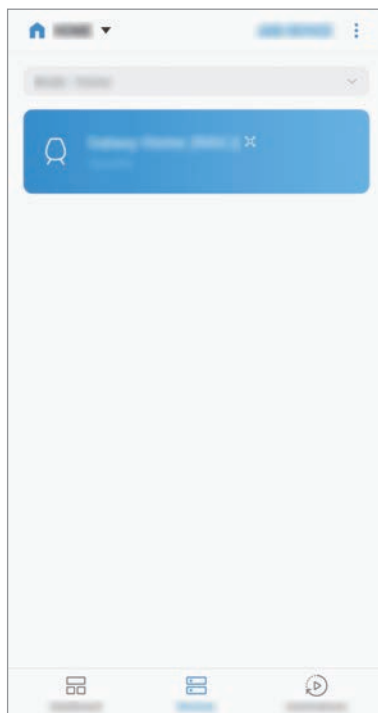



The (XXXX) appearing with the speaker name is the last four digits of the speaker's serial number. The serial number of the speaker is on the label attached to the connecting leg.

Tap the card. The Galaxy Home screen will appear as shown below.

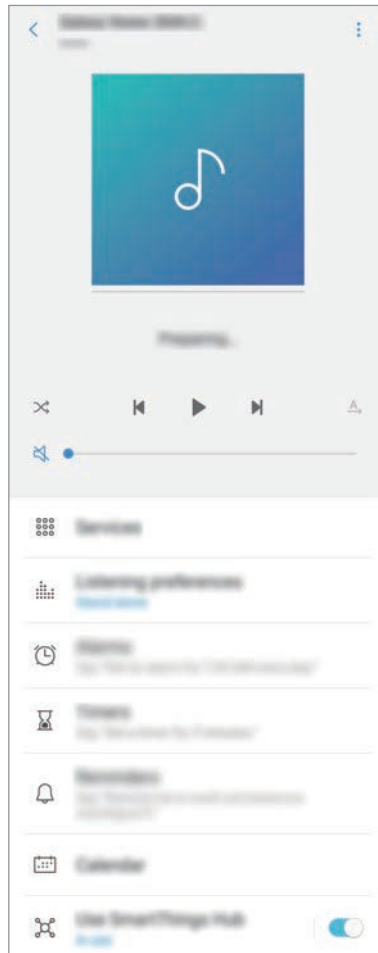

You can listen to music or change the settings of Bixby and the speaker on the Galaxy Home screen. Refer to [Controlling music through the SmartThings app](#) or [Bixby settings, General settings](#) for more information.

Setup for iPhones (or if the connection pop-up window does not appear)

- 1 On your smartphone, launch the **SmartThings** app and move close to the speaker.
- 2 On the dashboard of the **SmartThings app**, tap **Add device**.
- 3 When your speaker is detected, select it and follow the on-screen instructions to complete the connection.

When the connection is completed, the **Galaxy Home (XXXX)** card will appear on the devices list.

Understanding initial setup

- If the initial setup is not completed or the speaker is not detected, unplug the power cable from the speaker and connect it again.
- After completing the initial setup, the Wi-Fi and the Samsung account information will be registered to your speaker and you can use the speaker by itself. Even if you unplug the power cable from the speaker and reconnect it, you can use the speaker without any configuration.
- Alarms, timers, reminders, or events on the calendar are saved on the speaker and your Samsung account. They are not saved on your smartphone.

Q I want to use the speaker when Wi-Fi is not connected.

A You can use the speaker as a Bluetooth speaker. If you have not yet performed the initial setup, you can connect with other devices with the method described below.

1. Press and hold the Play/Pause button more than 3 seconds.

The speaker enters Bluetooth pairing mode and the indicator light flashes red, green, and blue.

2. Turn on the Bluetooth feature on the device you want to connect to and complete the pairing.

When the pairing is complete, the indicator light flashes blue three times.

If you have already completed the initial setup, refer to [Using the speaker through Bluetooth](#).

Q The speaker freezes.

A Unplug the power cable from the speaker and connect it again. Then, check that the Wi-Fi works properly. If the problem is still not resolved, contact a Samsung Service Center.

Using the speaker

Using Bixby

Tell Bixby what you want. Then, Bixby will launch the function you request or tell you the information you want to know.

1 Say "Hi, Bixby".

When the speaker emits a sound and the circle LED turns on, Bixby wakes up and you can start a conversation.

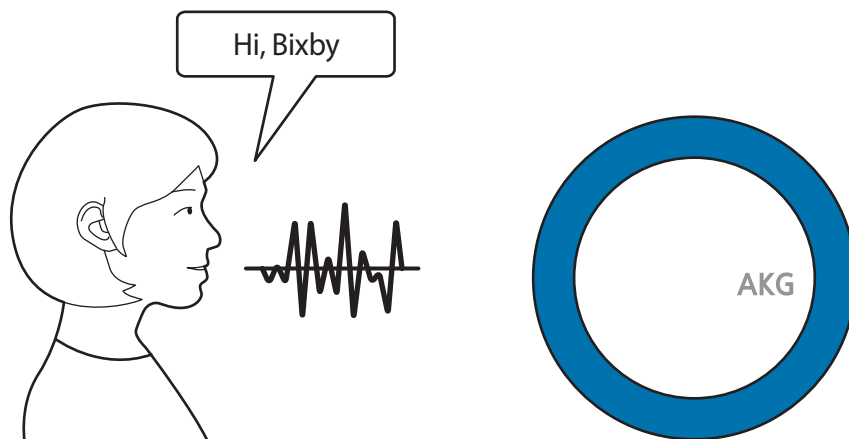

2 When Bixby wakes up, say what you want.

Bixby recognizes it and launch a function or tell the information you request.

When Bixby is recognizing your request, the circle LED lights up clockwise.



For example, if you say “Play music.” the speaker will play music.

When Bixby does not understand your request, it will give voice feedback appropriate to the situation.

Tips for better voice recognition

- Speak clearly.
- Speak in quiet places.
- Do not use offensive or slang words.
- Avoid speaking in dialectal accents.



- To use Bixby, say “Hi, Bixby” to wake it up. When Bixby wakes up, the circular LED light turns on. Bixby will return to standby mode after 5 seconds.
- The examples of Bixby usage in this guide may not work depending on the software version of the speaker or the environment.
- Use the speaker in a quiet place. If you use it in a noisy environment, such as a place where the TV is on, Bixby may unintentionally respond or the voice recognition rate may drop.

Q Bixby does not understand me.

A To make Bixby launch functions more accurately, include the name of the app and the feature.

For example, say “Meeting at 2 PM tomorrow, save to the calendar.”

Q Bixby does not wake up.

A Press and hold the Play/Pause button on the touch panel for 1 second. Bixby will wake up.

Q Bixby keeps listening to my conversation so I’m worried about privacy.

A Bixby does not listen what you are saying when the microphones are turned off or when it is not awakened by saying “Hi, Bixby.”

To turn off the microphone, cover the palm touch area with your palm. The indicator light will flash red and the microphone will turn off.

To turn on the microphone, cover the palm touch area with your palm again.

The indicator light will turn off and you can wake up Bixby by saying “Hi, Bixby.”

Viewing what Bixby has saved

The SmartThings app allows you to view alarms, timers, and reminders saved by Bixby. You can also delete or change the details.

- 1 On your smartphone, launch **SmartThings** app.
- 2 Tap **Devices** and select your speaker.
Galaxy Home screen will appear.

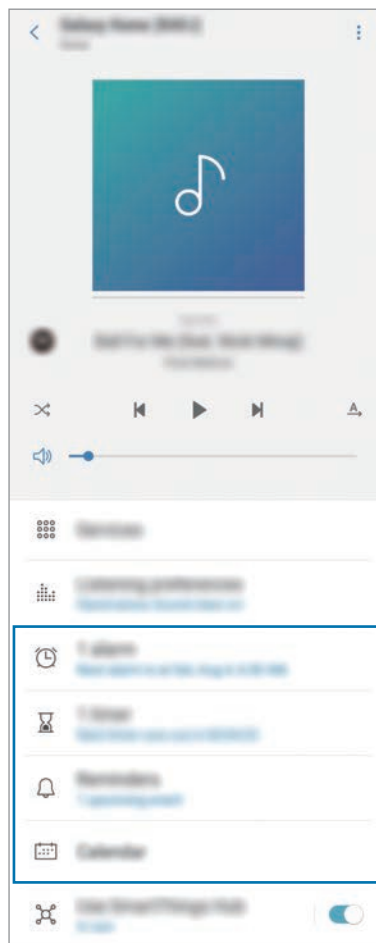

3 Select an option.

- **Alarms:** You can view and delete the saved information. You can also change the alarm sound.

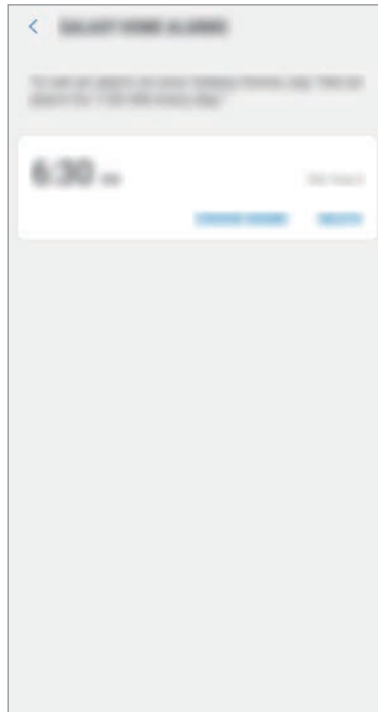

- **Timers:** You can check the remaining time and stop the timer.

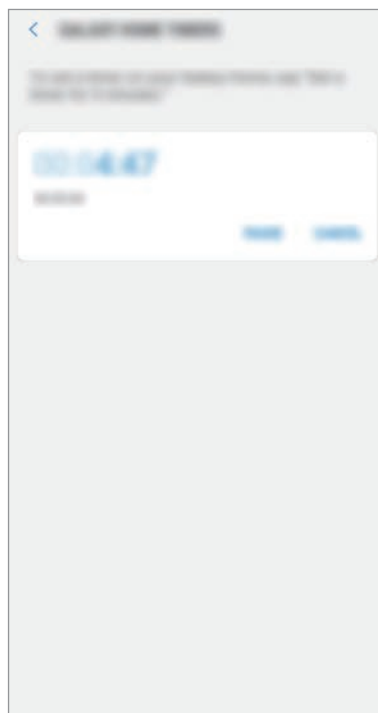

- **Reminders:** You can view and delete saved information.

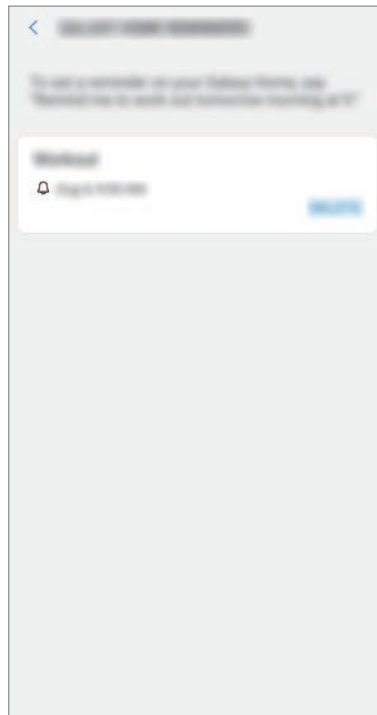

- **Calendar:** You can view the default calendar where the upcoming events are saved, or you can select and set a default calendar from among multiple calendars.

Bixby basic settings

Changing Bixby language

You can set the language that Bixby will use.

- 1 On your smartphone, launch the **SmartThings** app.
- 2 Tap **Devices** and select your speaker.
The Galaxy Home screen will appear.
- 3 Tap  → **Settings** → **Language** and select a language.



Bixby is only available in some languages.

Setting up the Bixby notifications

You can set up a notification sound for when Bixby starts and stops listening.

- 1 On your smartphone, launch the **SmartThings** app.
- 2 Tap **Devices** and select your speaker.
The Galaxy Home screen will appear.
- 3 Tap  → **Settings** → **Feedback and notifications** → **Sound feedback**.
 - To hear a notification sound when Bixby starts listening, tap the **When Bixby starts listening** switch to activate it.
 - To hear a notification sound when Bixby stops listening, tap the **When Bixby stops listening** switch to activate it.

Bixby usages

You can launch various functions by voice through Bixby.

Creating events

If you are worried about forgetting plans for a specific date, tell Bixby.

For example, say "Hi, Bixby, make a meeting event for 4 PM tomorrow."

Check out what to do today

You can quickly receive today's schedule.

Tell Bixby, "Hi, Bixby, read today's schedule."

Bixby tells you the events and reminders for today.

Setting alarms and timers

If you want to receive an alarm at a certain time, tell Bixby "Hi, Bixby, set an alarm for 6 AM tomorrow morning." To set a timer, tell Bixby "Hi, Bixby, set a timer for 10 minutes."

The speaker will notify you at the set time.

To turn off the alarm or timer, say "Hi, Bixby, dismiss alarm." Or, press the Play/Pause button on the speaker's touch panel.

You can view the timers and alarms you set via Bixby in the SmartThings app. Refer to [Viewing what Bixby has saved](#) for more information.

Creating reminders

If you have anything you want to remember, tell Bixby. Bixby will not forget to inform you when it is time.

For example, say, "Hi, Bixby, remind me to workout tomorrow morning at 9 AM."

Bixby saves it to reminders and notifies you at the appointed time.

You can also view reminder set up by Bixby in the SmartThings app. Refer to [Viewing what Bixby has saved](#) for more information.

Registering IoT products

You can register your IoT products with Bixby. IoT products are registered to the same Samsung account as the speaker.

1 Set the connection mode of the IoT product you want to connect with.

2 Say "Hi, Bixby, add a new device."

Your device will search for IoT products and register them.



- Samsung SmartThings Hub features may not be available in all countries. You can view more information at www.samsung.com.
- Only IoT devices certified by Samsung Electronics can be connected and used. You can view the certified devices at www.samsung.com.
- Refer to the product's user manual for details on how to enter connection mode.

To make it easier to use registered IoT products, register a location with the SmartThings app and configure any desired modes or automations. For more information, please refer to the explanations and instructions in the SmartThings app.

Controlling IoT products

You can control SmartThings products registered to the Samsung account which is registered to your speaker. The following are examples of commands that you can give to SmartThings through Bixby:

- Hi, Bixby, turn on living room TV.
- Hi, Bixby, turn on the air conditioner in the living room at 10.
- Hi, Bixby, please turn on the wind free mode for the living room air conditioner in the home.
- Hi, Bixby, run good morning scene in home.

Find My Phone

If you misplace your smartphone, the speaker can help you find it.

Just say “Hi, Bixby, find my phone,” or “Hi, Bixby, where is my phone?”

Your smartphone emits sounds and the screen turns on.



- This feature is only available when the smartphone is logged into the same Samsung account as the speaker.
- This feature is only supported for Samsung Android smartphones. It may not be available in some models.

Launching other features

Ask Bixby about news, weather, and other things. Bixby will search for and provide you with related information and services on the Internet. Use the following phrase:

- Hi, Bixby, what's the weather this week? (Weather)
- Hi, Bixby, tell me today's news. (News)
- Hi, Bixby, how high is Mt. Everest? (General information)
- Hi, Bixby, how many centimeters is 25 inches? (Unit conversion)
- Hi, Bixby, 5 plus 10 times 4. Please calculate. (Calculation)
- Hi, Bixby, please mute. (Volume control)

You can view more supported services and usages for Bixby. On your smartphone, launch the **SmartThings** app and tap **Devices**, select your speaker, and tap **Services**.



Available Bixby services may differ depending on the region.

Playing music

Listening to music with Bixby

Tell Bixby play music. You can listen to music through the music streaming services which support Bixby.

Say, "Hi, Bixby, play music." If there is no music you have been listening to, Bixby plays the latest music.

You can also ask for a specific singer or request music that suits your situation or mood as well as specify a certain music streaming service. Use the following commands:

- Hi, Bixby, play songs of (name of an artist or group).
- Hi, Bixby, play an album by (name of an artist or group).
- Hi, Bixby, play (song title) by (name of the singer or group).
- Hi, Bixby, play songs that are good for mornings.
- Hi, Bixby, play exciting music.
- Hi, Bixby, play (song title) by (name of the singer or group) on (music streaming app).
- Hi, Bixby, play songs that are good for mornings on (music streaming app).
- Hi, Bixby, play exciting music on (music streaming app).

You can also use Bixby while playing music. You can say "Hi, Bixby, tell me the title of the song." Or, "Hi, Bixby, tell me the singer of this song."

Setting music apps

You can set the music streaming app that will be launched when you ask Bixby play music.

- 1 On your smartphone, launch the **SmartThings** app.
- 2 Tap **Devices** and select your speaker.
The Galaxy Home screen will appear.
- 3 Tap **Services**.
The services that Bixby supports will appear.
- 4 Select the music streaming service you want and tap .
The app you selected is set as your primary music app.

Controlling music with Bixby

You can use Bixby while music is playing. Use voice controls like the following:

- Pause or resume music: "Hi, Bixby, stop music." Or, "Hi, Bixby, play music."
- Play the next song: "Hi, Bixby, play the next song."
- Play the previous song: "Hi, Bixby, play the previous song."
- Adjust the volume: "Hi, Bixby, turn the volume up." Or, "Hi, Bixby, turn down the volume."

When you adjust the volume, the circle LED will incrementally on or off clockwise or counterclockwise.

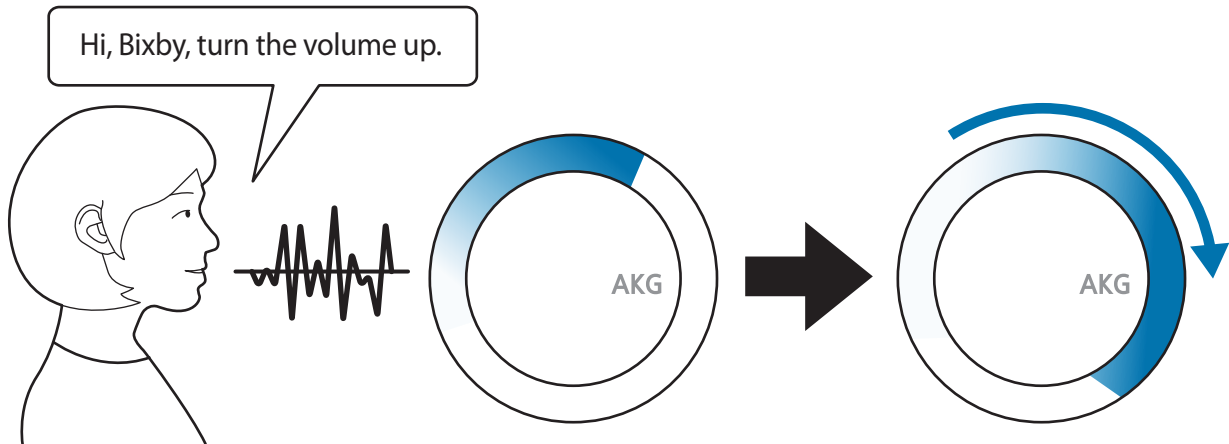

- Shuffle: "Hi, Bixby, shuffle play."
- Repeat: "Hi, Bixby, repeat this song."
- Favorites: "Hi, Bixby, play favorite songs."

Controlling music through the touch panel

You can control the music by using the touch panel. If it is difficult to control the music by voice, use the touch panel.

- Pause or resume music: Press the Play/Pause button.
- Play the next song: Press the Next button.
- Play the previous song: Press the Previous button.
- Adjust the volume: Press the Volume Up or Volume Down button. Press and hold the volume button to increase or decrease the volume incrementally.

Controlling music through the SmartThings app

You can control the music in the SmartThings app.

On your smartphone, launch the **SmartThings** app and tap **Devices** and select your speaker. The Galaxy Home screen will appear.

Launch any features in the music playback screen area.



The screen may vary depending on the music streaming service app you use.

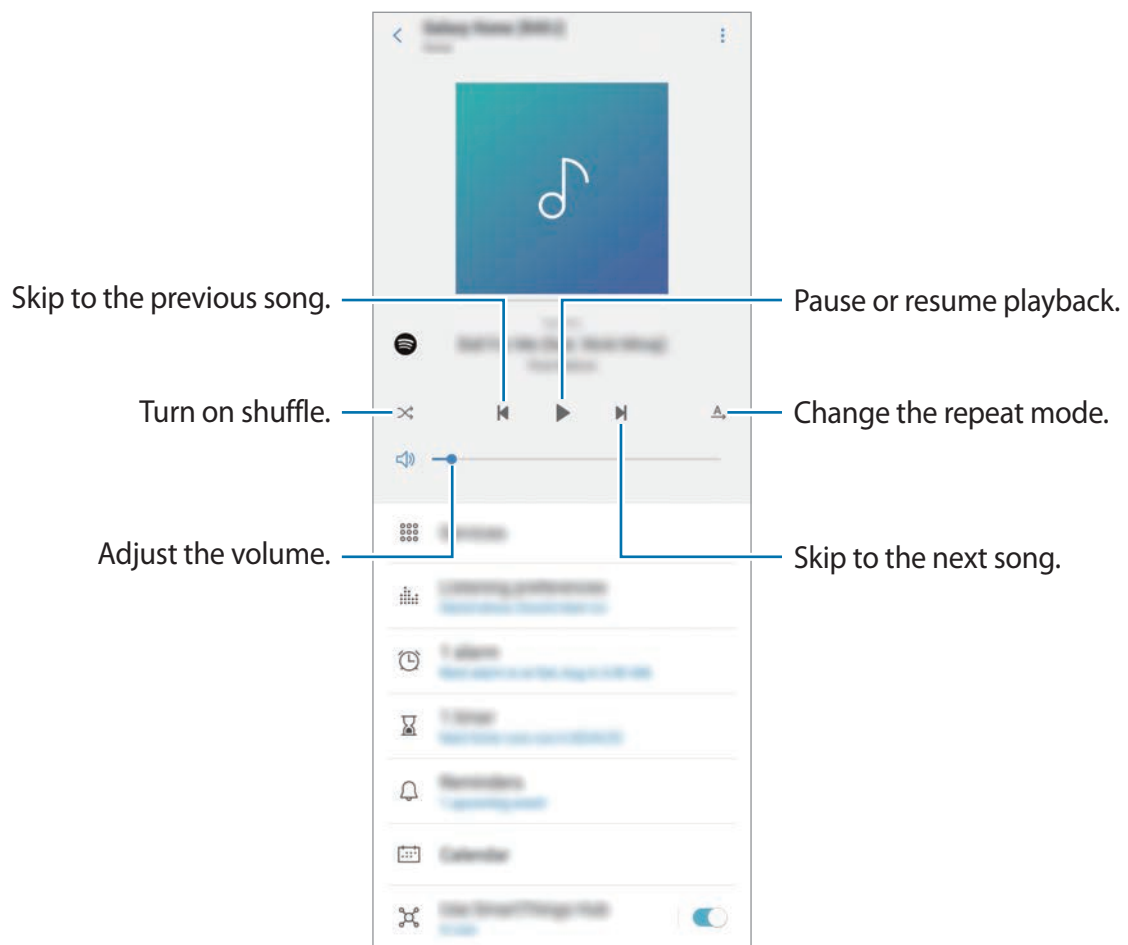

You can control your music remotely. You can turn on your music at home for your family or pets when you are out, or you can turn it on if you do not want to come back to a quiet home. The last music you listened to on your smartphone's Spotify will play.

However, if you change your smartphone's Spotify account, the last song you listened to using the speaker will play.

Listen with sound optimized for your location (SoundSteer)

With the SoundSteer feature, you can create a Sweet Spot (the point where the sound quality is maximized) in your direction so that you can enjoy optimum sound quality.

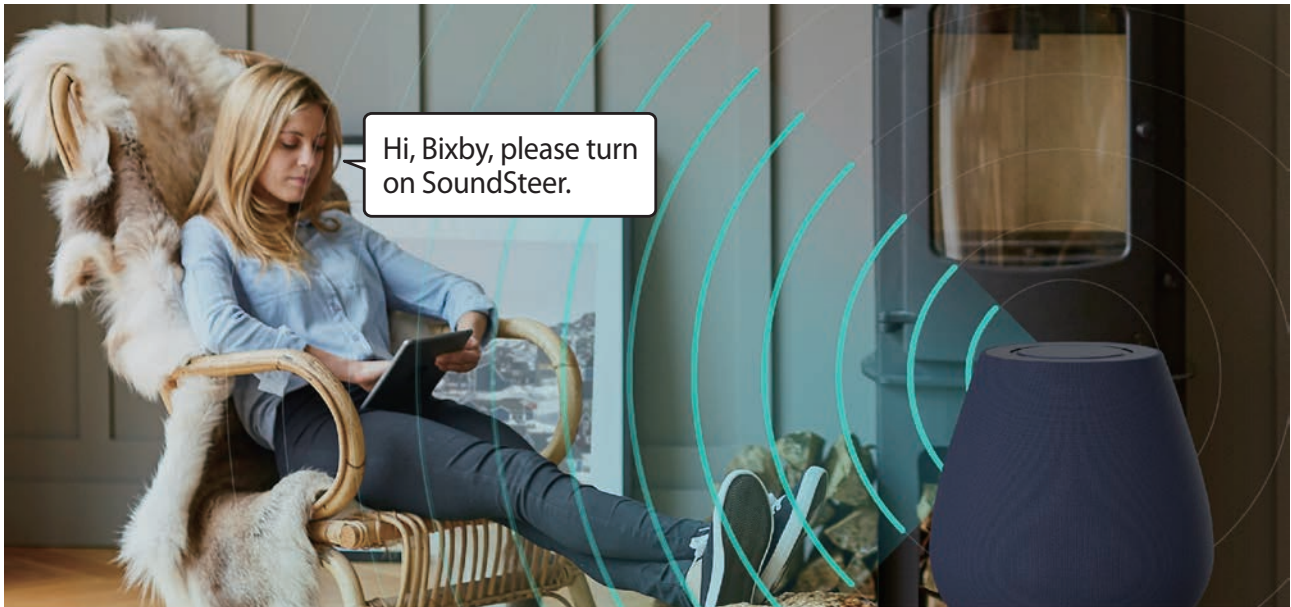

While playing music, say, "Hi, Bixby, please turn on SoundSteer." The music then plays so you can hear the optimized sound in your direction.

Turning on the SoundSteer feature with the SmartThings app

You can also turn on the SoundSteer feature through the SmartThings app.

- 1 On your smartphone, launch the **SmartThings** app.
- 2 Tap **Devices** and select your speaker.
The Galaxy Home screen will appear.
- 3 Tap **Listening preferences** and tap the **SoundSteer** switch to activate it.

- 4 Tap **ADJUST** as shown on the screen, rotate the dial to adjust the direction, and tap **SAVE**.

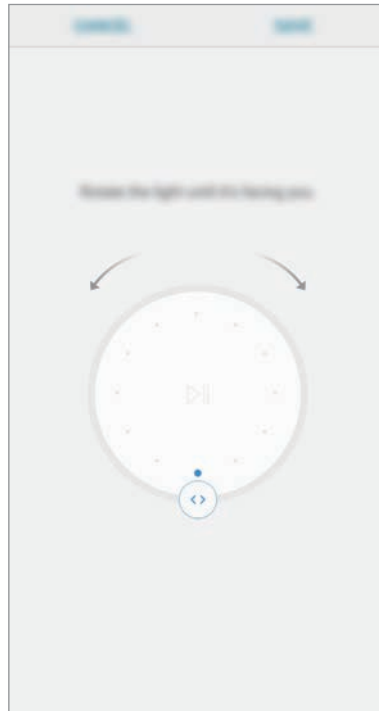

Setting stereo sound

If you have multiple speakers, you can connect them to enjoy music at the same time and listen with more realistic sound.

- 1 On your smartphone, launch the **SmartThings** app.
- 2 Tap **Devices** and select your speaker.
The Galaxy Home screen will appear.
- 3 Tap **Listening preferences** → **Mode**.
 - **Stand-alone**: Listen in mono sound.
 - **Stereo**: Connect two speakers and listen in stereo sound. Set the speakers to the left and to the right.
 - **Multi-room**: Use more than one speaker or other Wi-Fi speakers at the same time. You can use speakers in different places at the same time. Select the main speaker and select other speakers that you would like to use as well.

Using the speaker through Bluetooth

You can use the product by connecting it with another device via Bluetooth.

1 Say "Hi, Bixby, turn on the Bluetooth feature."

The speaker enters Bluetooth pairing mode and the indicator light flashes red, green, and blue.

You can also enter Bluetooth pairing mode with the SmartThings app. On your smartphone, launch the **SmartThings** app and tap **Devices** to select the speaker. Tap  → **Settings** → **Bluetooth** → **OK**.

2 Turn on the Bluetooth feature on the device you want to connect with and complete the pairing.

When the pairing is complete, the indicator light flashes blue three times.



When connected with Bluetooth, you cannot control the volume, play the next song or previous song, or pause with Bixby. You can only control the speaker from the touch panel or the **SmartThings** app.

Configuring the speaker

Viewing product registration information

You can view various information registered to the product.

1 On your smartphone, launch **SmartThings** app.

2 Tap **Devices** and select your speaker.

The Galaxy Home screen will appear.

3 Tap  → **My profile**.

- View the Samsung account registered to the speaker.
- **Services:** View services supported by Bixby and examples of how to use them.
- **Quick commands:** View quick commands you have saved. Adding quick commands allows you to combine multiple commands into one command, or to speak a long command quickly and easily.

For example, before going to bed, register the request to “turn off the TV, turn off the air conditioner.” to a quick commands as “Good night, Bixby.” When you say “Good night, Bixby,” the requests you have registered with the quick command will be processed at once.

Bixby settings

Change the settings related to Bixby using the **SmartThings** app.

- 1 On your smartphone, launch **SmartThings** app.
- 2 Tap **Devices** and select your speaker.
The Galaxy Home screen will appear.
- 3 Tap  → **Settings** to change Bixby settings.

Language

You can set the language that Bixby will use. Refer to [Changing Bixby language](#) for more information.

Feedback and notifications

Change the settings related to notifications.

- **Sound feedback:** Set to hear an audible sound when Bixby starts to listen or when it stops. Refer to [Setting up the Bixby notifications](#) for more information.
- **Do not disturb:** Activate do not disturb mode to mute notifications and turn off the speaker's lights. Alarms and timers are exceptions.
- **Notifications:** Select the type of notification you want to receive. You can change the settings for categories such as Emergency, Appliances and sensors, and General.

Privacy

For some of the services supported by Bixby to operate properly, they may need permission to access or use information on your smartphone. You can view the app's permissions list and change its permissions for each service.

General settings

Change the settings related to the speaker using **SmartThings** app.

- 1 On your smartphone, launch **SmartThings** app.
- 2 Tap **Devices** and select your speaker.
The Galaxy Home screen will appear.
- 3 Tap  → **Settings** to change settings.
 - **Bluetooth**: Turn the speaker's Bluetooth feature on or off.
 - **Voice dialing**: Add contacts by importing them from other devices to your speaker. You can make phone calls to your contacts through Bixby. The product and smartphone should be close when calling. The quality of the call may vary depending on the surrounding environment, such as whether there are walls or other obstacles.
 - **Geolocation**: View or change the current location of the speaker. Bixby uses this information to inform you of the weather and news.
 - **Software update**: Update the speaker to the latest software.
 - **DEVICE DETAILS**: Check the speaker's information, such as the Wi-Fi MAC address, Bluetooth address, and serial number.

Software update

Update your device's software via the firmware over-the-air (FOTA) service. You can download updates automatically when connected to a Wi-Fi network.

You can also download updates manually.

- 1 On your smartphone, launch **SmartThings** app.
- 2 Tap **Devices** and select your speaker.
The Galaxy Home screen will appear.
- 3 Tap  → **Settings** → **Software update**.
- 4 Tap **Check for updates**. If there is the newer version of the software, download and install it.

Q I want to register another Samsung account to the speaker. (Factory reset)

A Press and hold the Play/Pause button and the Volume Down button for more than 7 seconds to initialize the speaker. When the initialization is complete, you will hear Bixby's welcome message. Do not unplug the power cable until rebooting has been completed.

Q The Wi-Fi information has changed.

A Sign in to the **SmartThings** app with the Samsung account registered to your speaker. On the dashboard screen, tap  → **Settings** → **Update Wi-Fi information** to select your device and tap **Update** to enter the new Wi-Fi information.

Appendix

Troubleshooting

Before contacting a Samsung Service Center, please attempt the following solutions. Some situations may not apply to your speaker.

Your speaker does not turn on

When the battery is completely discharged, your speaker will not turn on. Fully charge the battery completely before turning on the speaker.

The touch panel responds slowly or improperly

- If you attach a screen protector or optional accessories to the touchscreen, the touchscreen may not function properly.
- If you are wearing gloves, if your hands are not clean while touching the touch panel, or if you tap the panel with sharp objects or your fingertips, the touch panel may malfunction.
- The touch panel may malfunction in humid conditions or when exposed to water.
- Restart your speaker to clear any temporary software bugs.
- If the touch panel is scratched or damaged, visit a Samsung Service Center.

Your speaker freezes or encounters an error

Try the following solutions. If the problem is still not resolved, contact a Samsung Service Center.

Restarting the speaker

If your speaker freezes or lags, you may need to close apps or turn off the speaker and turn it on again.

Forcing restart

If your speaker is frozen and unresponsive, press and hold the Power key and the Volume Down key simultaneously for more than 7 seconds to restart it. When the initialization has completed, the speaker reboots and displays a welcome message. Do not disconnect the power cable until it has rebooted.

Calls are not connected

- Ensure that your smartphone is within Bluetooth range (10 m).
- Ensure that you have not set call barring for the incoming phone number.

Others cannot hear you speaking on a call

Ensure the microphone is not switched off or hidden by other objects.

A small gap appears around the outside of the speaker case

- This gap is a necessary manufacturing feature and some minor rocking or vibration of parts may occur.
- Over time, friction between parts may cause this gap to expand slightly.

Bixby does not respond

- Ensure the Wi-Fi is working properly.
- Ensure that the microphone is not turned off or that you are not covering the built-in microphone.
- Ensure that the you speak closer to the microphone.

The call or the Wi-Fi connection is often disconnected or audio quality is poor

- Ensure the Wi-Fi is working properly.
- Ensure that the microphone is not turned off or the speaker is not blocked by other devices.
- Voice recognition may not function properly in noisy places.
- Restart your speaker to clear any temporary software bugs.
- Ensure that your speaker software is updated to the latest version.
- If you are still having trouble with Bixby Voice after trying these tips, contact a Samsung Service Center.

The speaker cannot connect to smartphone

You cannot connect in a Wi-Fi environment with a firewall installed. If your smartphone is connected to Wi-Fi with a firewall enabled, reconnect to Wi-Fi with a firewall disabled and try again.

An IoT product does not work

- Ensure the product you want to run is registered on the SmartThings app.
- Ensure that the Samsung account you logged in to the SmartThings app is the same as the Samsung account registered in your speaker.
- Turn off the SmartThings app on your smartphone and try running it again.

Managing the speaker

- When the speaker is dirty, wipe it clean with a soft and dry cloth.
- Keep the speaker dry. Prevent liquid from coming into contact with or entering the speaker.
- When you will not be using the speaker for a long time, unplug the power cable from the electric socket.
- Do not place objects on top of the touch panel.

FCC Part 15.19

This device complies with part 15 of the FCC Rules. Operation is subject to the following two conditions: (1) This device may not cause harmful interference, and (2) this device must accept any interference received, including interference that may cause undesired operation.

FCC Part 15.21

Any changes or modifications (including the antennas) made to this device that are not expressly approved by the manufacturer may void the user's authority to operate the equipment.

Note : This equipment has been tested and found to comply with the limits for a Class B digital device, pursuant to part 15 of the FCC Rules. These limits are designed to provide reasonable protection against harmful interference in a residential installation. This equipment generates, uses and can radiate radio frequency energy and, if not installed and used in accordance with the instructions, may cause harmful interference to radio communications. However, there is no guarantee that interference will not occur in a particular installation. If this equipment does cause harmful interference to radio or television reception, which can be determined by turning the equipment off and on, the user is encouraged to try to correct the interference by one or more of the following measures:

- Reorient or relocate the receiving antenna.
- Increase the separation between the equipment and receiver.
- Connect the equipment into an outlet on a circuit different from that to which the receiver is connected.
- Consult the dealer or an experienced radio/TV technician for help.

Modifications not expressly approved by the manufacturer could void your authority to operate the equipment under FCC rules.

Samsung Electronics America, Inc

85 Challenger Road,

Ridgefield Park, New Jersey, 07660

Phone: 1-800-SAMSUNG (726-7864)

Copyright

Copyright © 2018 Samsung Electronics America, Inc.

This manual is protected under international copyright laws.

No part of this manual may be reproduced, distributed, translated, or transmitted in any form or by any means, electronic or mechanical, including photocopying, recording, or storing in any information storage and retrieval system, without the prior written permission of Samsung Electronics.

Trademarks

- SAMSUNG and the SAMSUNG logo are registered trademarks of Samsung Electronics.
- Bluetooth® is a registered trademark of Bluetooth SIG, Inc. worldwide.
- Wi-Fi®, Wi-Fi Protected Setup™, Wi-Fi Direct™, Wi-Fi CERTIFIED™, and the Wi-Fi logo are registered trademarks of the Wi-Fi Alliance.
- Z-Wave and Z-Wave Plus are registered trademarks of Silicon Laboratories and its subsidiaries in the United States and other countries.
- Zigbee and Zigbee Certified Product are registered trademarks of Zigbee Alliance.
- All other trademarks and copyrights are the property of their respective owners.

