

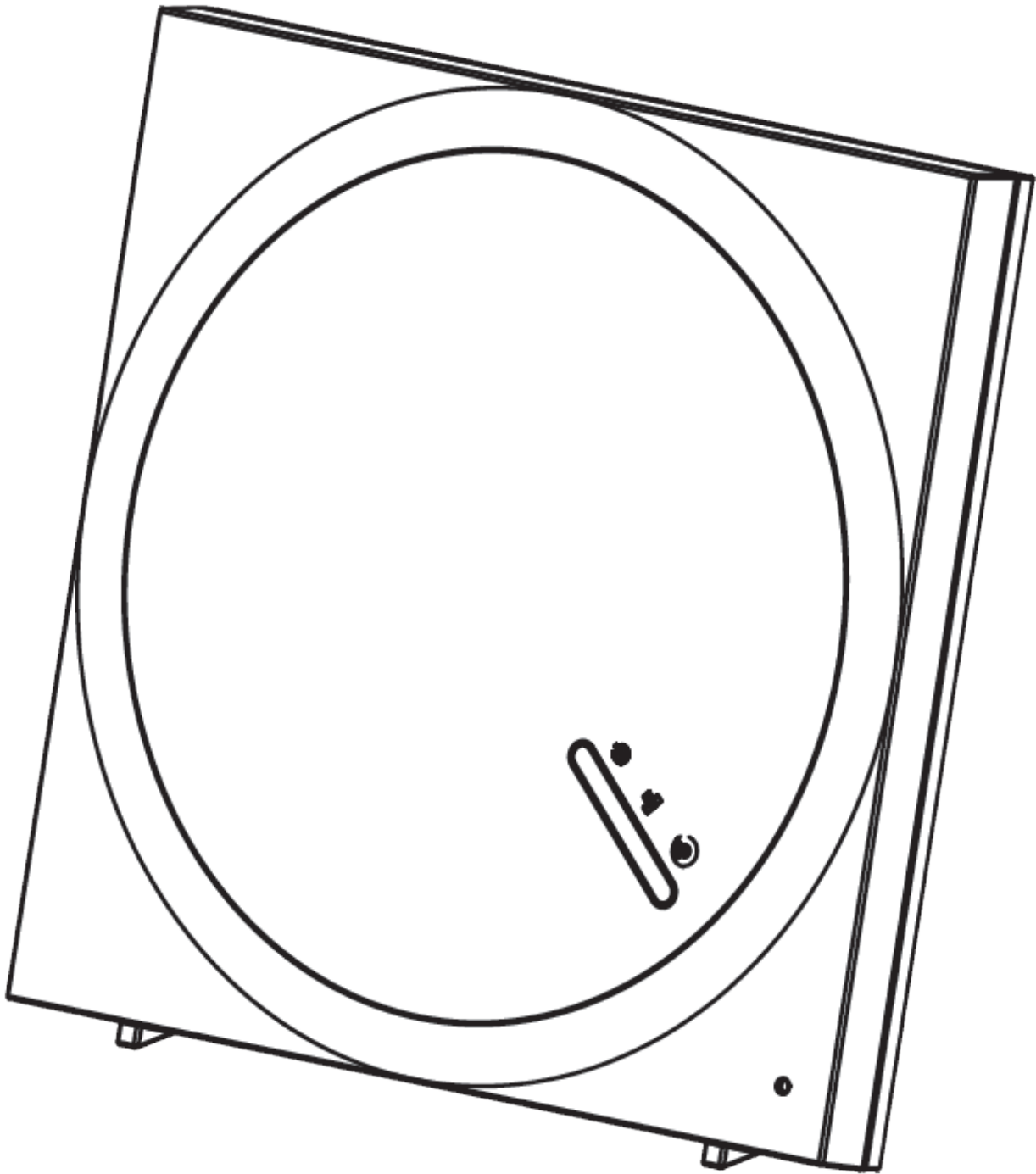

Security Tech Germany

SHGW10000

# QUICKGUIDE



Installing the Gateway

Supported Smartphone System Version:

**iOS: iPhone or iPad**

Requires iOS 6.0 or later

**Android Smartphone or Tablet**

Requires Android 4.0 or later

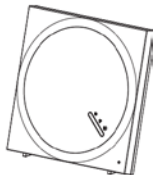

Step 1: Download the ABUS Z-Wave One APP



Step 2: Add the Gateway

Click on the „Add a gateway“ and follow the further instructions in the app.

Step 3: Login

Press the Gateway icon to log in to the Gateway.

Assign a secure administrator access now by entering an admin account name and password.

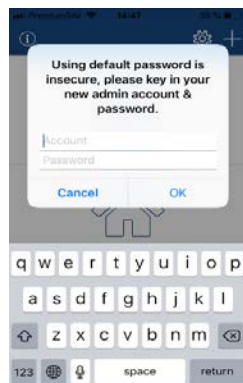

Step 4: Add a Z-Wave Component

To add a Z-Wave device into the Gateway (Inclusion), follow the steps below:

1. Set the gateway inclusion mode
  - a. Press "Component"
  - b. Press „+“
  - c. Choose between ABUS devices or other devices
  - d. Follow the inclusion steps of the respective device
  
2. When the gateway detects the Z-Wave component, a "Di" tone is output.
  
3. After you have assigned a name to the component, the gateway confirms the successful inclusion with a success tone.

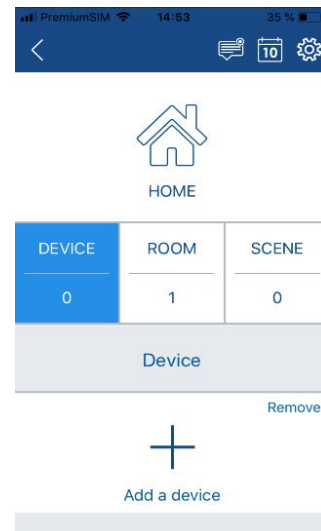

*Note: If the inclusion failed, check whether The Z-Wave frequency of the device is the same as of the Gateway (EU). It may be necessary to exclude the device before attempting to include it again. Select the "-" symbol in the component view here and perform the exclusion procedure.*

Step 5: Add a new room

1. Press the „Room“ Icon
2. Press „+“
3. Assigning a name

After a room has been created, included devices can be added to it. To do this, either go to the room overview and press “+” to add device or assign the room in the device overview.

If temperature, humidity and/or brightness sensors have been added to a room, the respective values are displayed as a preview in the room overview. If there are several devices with the same parameter, you can choose which value shall be displayed in the preview.

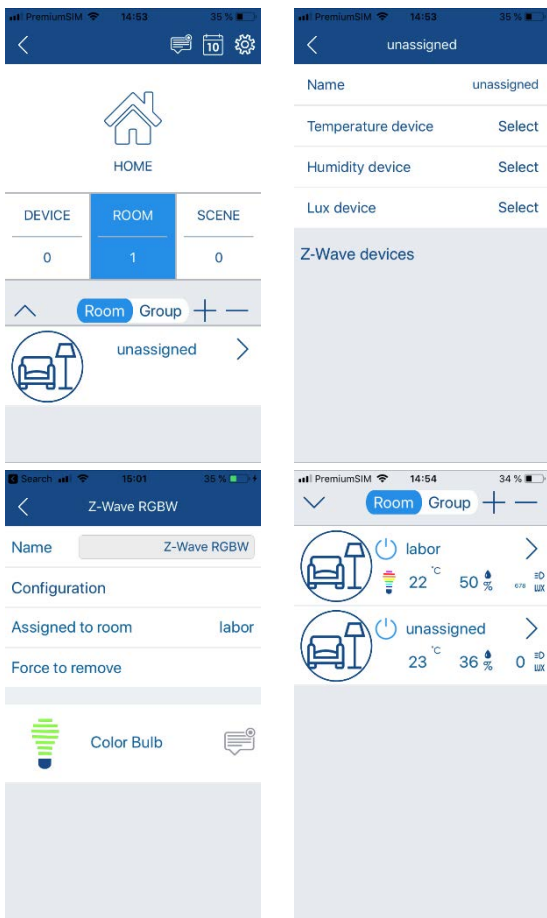

Step 6: Create a new scene

Up to 60 scenes can be created on each gateway, each scene consists of IF/THEN/WHEN elements.

“IF” is the condition under which the scene is to be triggered, up to 6 conditions per scene are possible. These can be and/or based. The “IF” conditions can be set according to the status of the Z-Wave devices, Smartvest, room conditions or gateway status.

“THEN” are the actions of the scene, up to 6 actions are possible per scene. The “THEN” actions can be applied to Z-Wave devices, Smartvest, room actions or gateway status.

“WHEN” allows the scene to check different conditions which conditions can be, e.g. always, every day, every week or during a certain period of time. When no time interval is assigned, the condition “always” will be applied automatically.



FAQ

**What should I do if I have forgotten my password?**

During operation, press the reset button on the back of the device for five seconds. The gateway then restores the standard admin access and standard network configuration (DHCP).

**How do I exclude a device from the component list if it is defective or lost?**

If your device can no longer establish a connection to the gateway, it can be removed from the gateway by pressing the following ICON:



*Note: If a device does not respond for more than 24 hours, the  symbol appears*

**Why my device cannot be included?**

1. Make sure that your Z-Wave gateway and the device communicate on the same frequency.
2. Your device may already be connected to another Z-Wave network, so try an exclusion first.
3. The battery of the device is empty.

**What is the default admin login?**

Standard admin user: admin

Standard admin password: \_\_\_\_\_ (empty)

Scope of delivery

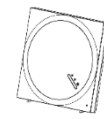

Gateway



ID / Password Card



Quickguide



Ethernet Cable

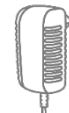

Power Supply 5V / 1,5A

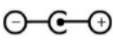
(DC-Stecker: 3,5 x 1,35mm) 

Product description

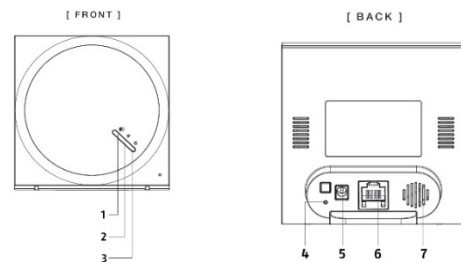

1	Z-Wave LED-Indicator
2	Netzwerk LED-Indicator
3	Status LED-Indicator
4	Reset-Button
5	Power Supply (5V DC / 1A)
6	LAN-interface
7	Speaker

Reset – Factory Default

To completely reset your Z-Wave Gateway to factory settings, connect to the device using the ABUS Z-Wave One App. Open the configuration and select the option "Z-Wave Factory Settings" in the admin area.

If this controller is the primary controller for your network, resetting it will result in the nodes in your network being orphaned and it will be necessary after the reset to exclude and re-include all of the nodes in the network. If this controller is being used as a secondary controller in the network, use this procedure to reset this controller only in the event that the network primary controller is missing or otherwise inoperable.

Z-Wave configuration

**Association group**

Group No.	Max. Nodes	Description
1	1	Z-Wave Plus Lifeline, report Device Reset Locally when reset

**Device Detection**

Added device will detect automatically, users can control it (on/off, change color, lighting, etc.) and watch information (battery, meter, etc.) via Z-Wave ONE App.

**Different brands**

Z-Wave enabled device can be included and excluded normally. Included devices will show on device list. All non-battery powered nodes can act as repeaters regardless of manufacturers.

**Basis command**

Basic command is useful in a scene.

**Replication**

Controller can transmit protocol replication data automatically.

**About Security**

This controller is a security enabled Z-Wave Plus product. If necessary, it will use encrypted Z-Wave Plus messages to communicate to other security enabled Z-Wave Plus products.

**BASIC SET**

For unknown device, press device icon will show on/off icon, select on/off and press ok will send BASIC SET 0xff/0x00.

Z-Wave Command Classes

**Supported Z-Wave Command Classes:**

- COMMAND\_CLASS\_ZWAVEPLUS\_INFO\_V2
- COMMAND\_CLASS\_VERSION\_V2
- COMMAND\_CLASS\_ASSOCIATION\_GRP\_INFO
- COMMAND\_CLASS\_ASSOCIATION\_V2
- COMMAND\_CLASS\_MANUFACTURER\_SPECIFIC\_V2
- COMMAND\_CLASS\_SECURITY
- COMMAND\_CLASS\_SECURITY\_2
- COMMAND\_CLASS\_DEVICE\_RESET\_LOCALLY
- COMMAND\_CLASS\_APPLICATION\_STATUS
- COMMAND\_CLASS\_POWERLEVEL
- COMMAND\_CLASS\_CONTROLLER\_REPLICATION
- COMMAND\_CLASS\_BASIC
- COMMAND\_CLASS\_CRC\_16\_ENCAP
- COMMAND\_CLASS\_TRANSPORT\_SERVICE\_V2
- COMMAND\_CLASS\_SUPERVISION

**Controlled Command Classes:**

- COMMAND\_CLASS\_BASIC
- COMMAND\_CLASS\_SECURITY
- COMMAND\_CLASS\_SECURITY\_2
- COMMAND\_CLASS\_ASSOCIATION\_GRP\_INFO
- COMMAND\_CLASS\_ASSOCIATION\_V2
- COMMAND\_CLASS\_WAKE\_UP\_V2
- COMMAND\_CLASS\_MULTI\_CHANNEL\_V4
- COMMAND\_CLASS\_SWITCH\_BINARY
- COMMAND\_CLASS\_SWITCH\_MULTILEVEL\_V2
- COMMAND\_CLASS\_SENSOR\_BINARY\_V2
- COMMAND\_CLASS\_SENSOR\_MULTILEVEL
- COMMAND\_CLASS\_METER
- COMMAND\_CLASS\_COLOR\_CONTROL
- COMMAND\_CLASS\_DOOR\_LOCK
- COMMAND\_CLASS\_NOTIFICATION\_V4
- COMMAND\_CLASS\_BATTERY
- COMMAND\_CLASS\_SENSOR\_ALARM
- COMMAND\_CLASS\_INCLUSION\_CONTROLLER
- COMMAND\_CLASS\_CRC\_16\_ENCAP



Security Tech Germany

- ⒹⒺ Eine alternative Inbetriebnahme sowie detaillierte Informationen erhalten Sie in der Bedienungsanleitung erhältlich auf der Website:  
[abus.com/product/SHGW10000](https://abus.com/product/SHGW10000)
- ⒻⒻ Vous trouverez une alternative de mise en service ainsi que des informations détaillées dans le manuel d'utilisateur disponible sur le site Internet : [abus.com/product/SHGW10000](https://abus.com/product/SHGW10000)
- ⒼⒶ Een alternatieve ingebruikname en gedetailleerde informatie vindt u in de gebruikershandleiding op de website: [abus.com/product/SHGW10000](https://abus.com/product/SHGW10000)
- ⒾⒿ Per informazioni su una messa in funzione alternativa o sui dettagli del prodotto, consultare le istruzioni per l'uso disponibili all'indirizzo:  
[abus.com/products/SHGW10000](https://abus.com/products/SHGW10000)
- ⒸⒹ An alternative installation as well as detailed information can be found in the user manual which is available on the website:  
[abus.com/product/SHGW10000](https://abus.com/product/SHGW10000)
- ⒹⒾ Alternativ idrifttagning samt detaljerede oplysninger findes i betjeningsvejledningen, som findes på hjemmesiden:  
[abus.com/product/SHGW10000](https://abus.com/product/SHGW10000)
- ⒶⒾ Informacje dotyczące alternatywnych sposobów uruchomienia oraz dodatkowe szczegóły znajdują się w instrukcji obsługi, którą można pobrać na stronie: [abus.com/product/SHGW10000](https://abus.com/product/SHGW10000)
- ⒺⒺ En el manual de instrucciones disponible en nuestra página web podrá consultar una puesta en funcionamiento alternativa, así como información más detallada. [abus.com/product/SHGW10000](https://abus.com/product/SHGW10000)
- ⒺⒺ Alternativ idrifttagning samt detaljerad information finns i bruksanvisningen som kan hämtas på webbsidan: [abus.com/product/SHGW10000](https://abus.com/product/SHGW10000)