

Walli

Roll-Control

CE

Remote control of roller blinds, venetian blinds, pergolas, curtains, awnings and blind motors with electronic or mechanical limit switches

Compatible with
Yubii[®]
ECOSYSTEM

EN - Instructions and warnings for installation and use

1 WARNINGS AND GENERAL PRECAUTIONS

- **This manual contains important instructions and warnings for personal safety.** Carefully read all parts of this manual. If in doubt, suspend installation immediately and contact Nice Technical Assistance.
- **Using this product for different purposes than specified in this manual is strictly forbidden!**
- **All installation and connection operations must be performed exclusively by suitably qualified and skilled personnel with the unit disconnected from the mains power supply.**
- The product packaging materials must be disposed of in full compliance with local regulations.
- Never apply modifications to any part of the device. Operations other than those specified can cause malfunctions. The manufacturer declines all liability for damage caused by makeshift modifications to the product.
- Never place the device near the sources of heat or expose to naked flames. These actions can damage the product and cause malfunctions.
- The device is designed to operate in an electrical home installation. Faulty connection or use can result in a fire or electric shock.
- Even when the device is turned off, voltage can be present at its terminals. Any maintenance introducing changes to the configuration of connections or the load must be always performed with a disabled fuse.
- To avoid risk of electrical shock, don't operate the device with wet or moist hands.
- The manufacturer will not be held responsible for any damage or loss of warranty privileges for other connected devices if the connection isn't compliant with their manuals.
- Don't use in damp or wet locations, near a bathtub, sink, shower, swimming pool, or anywhere else where water or moisture are present.
- It isn't recommended to operate all of the roller blinds simultaneously. For safety reasons, at least one roller blind should be controlled independently, providing safe escape route in case of emergency.
- This product isn't a toy. Keep away from children and animals!

2 PRODUCT DESCRIPTION

Walli Roll-Control is a smart wall switch designed to control motors of roller blinds, awnings, venetian blinds and other single phase, AC powered devices with the Z-Wave® network.

It measures active power and energy consumed by the controlled load.

You can install it with a provided cover plate and switch button or other compatible.

2.1 - Main features

- Can be used with:
 - » Roller blinds
 - » Venetian blinds
 - » Awnings
 - » Blind motors with electronic or mechanical limit switches
- Can be used with Walli covers or other compatible covers such as G55, LC, SO
- Supports Z-Wave® network Security Modes: S0 with AES-128 encryption and S2 Authenticated with PRNG-based encryption.
- Works as a Z-Wave® signal repeater (all non-battery operated devices within the network act as repeaters to increase reliability of the network).

2.2. - Fully compatible Z-Wave Plus® device



This device can be used with all devices certified with the Z-Wave Plus® certificate and should be compatible with such devices produced by other manufacturers. All non-battery operated devices within the network will act as repeaters to increase reliability of the network. The device is a Security Enabled Z-Wave Plus® product and a Security Enabled Z-Wave® Controller needs to be used to fully utilize the product.

2.3 - Technical specifications



Walli Roll-Control is produced by Nice S.p.A. (TV).

Note

All technical specifications stated in this section refer to an ambient temperature of 20 °C (± 5 °C).

Nice S.p.A. reserves the right to apply modifications to the product at any time when deemed necessary, while maintaining the same functionalities and intended use.

Table 1 - Walli Roll-Control - Hardware parameters

| Parameter | Values / types |
|---|---|
| Power supply | 110 - 230 V~ 50/60 Hz |
| Rated load current | <ul style="list-style-type: none"> • 4A for motors with compensated power factor (inductive loads) • 13A for resistive loads |
| Compatible load types | <ul style="list-style-type: none"> •  Single-phase AC motors •  Resistive loads |
| Required limit switches | Electronic or mechanic |
| Recommended external overcurrent protection | 10 A type B circuit breaker (EU) 13 A type B circuit breaker (Sweden) |
| For installation in boxes | $\varnothing \geq 60$ mm, depth ≥ 40 mm |
| Recommended wires | cross-section area between 1.5 - 4.0 mm ² , stripped 11.5 - 13 mm of insulation |
| Radio frequency band | 868.0–868.6MHz 869.7–870.0MHz |
| Max. transmitting power | +6dBm |
| Range | <ul style="list-style-type: none"> • up to 50 m outdoors • up to 40 m indoors Depending on the terrain and building structure |
| Radio protocol | Z-Wave (500 series chip) |
| Ambient humidity | 10 – 95% RH without condensation |
| Operational temperature | 0 - 35°C |
| Dimensions (Height x Width x Depth) | 86 x 86 x 51 mm |
| Compliance with EU directives | RoHS 2011/65/EU RED 2014/53/EU |

Note

Radio frequency of individual device must be same as your Z-Wave hub. Check information on the box or consult your dealer if you aren't sure.

3 INSTALLATION

3.1 - Safety rules

-  **Connecting the device in a manner inconsistent with this manual may cause risk to health, life or material damage.**
- Don't power the device before fully assembling it in the mounting box.
- Connect only in accordance with one of the figures.
- Install only in flush mounting boxes compliant with a relevant national safety standards and with depth no less than 40 mm.
- Don't connect devices which aren't compliant with the specification or relevant safety standards.
- Don't connect heating devices.
- Don't connect SELV or PELV circuits.

3.2 - Preparing for installation

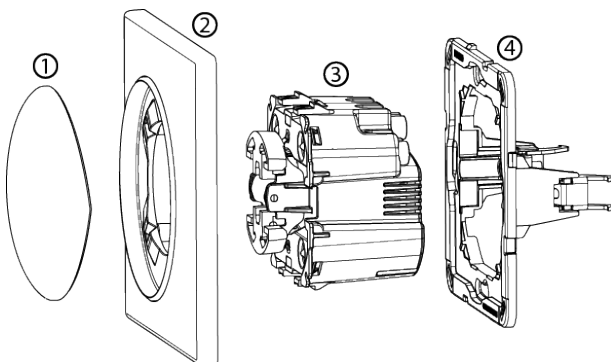
**Notes for Figure 1**

- 1 – switch button
- 2 – cover plate
- 3 – unit (device)
- 4 – mounting frame

Figure 1: Device parts

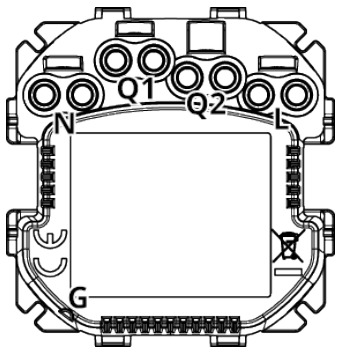

Notes for Figure 2

- N** – terminal for neutral wire
- Q1** – the 1st output terminal motor
- Q2** – the 2nd output terminal motor
- L** – terminal for live wire
- G** – groove used to measure wire length

Figure 2: Device terminals

Prepare wires by removing 11.5 -13 mm of insulation from their ends. You can use groove on the side of the unit to measure the length.

When installing with NICE or G55 cover plates:

1. Pull out the switch button.
2. Take off the cover plate.

When installing with LC or SO cover plates:

1. Pull out the original switch button.
2. Take off the original cover plate.
3. Dismount the original mounting frame.
4. Snap the new mounting frame.

Note

Additional mounting frames are sold separately. Make sure you have all required parts when installing with covers other than Nice.

3.3 - Electrical connection

1. Switch off the mains voltage (disable the fuse).
2. Connect with one of the figures below:

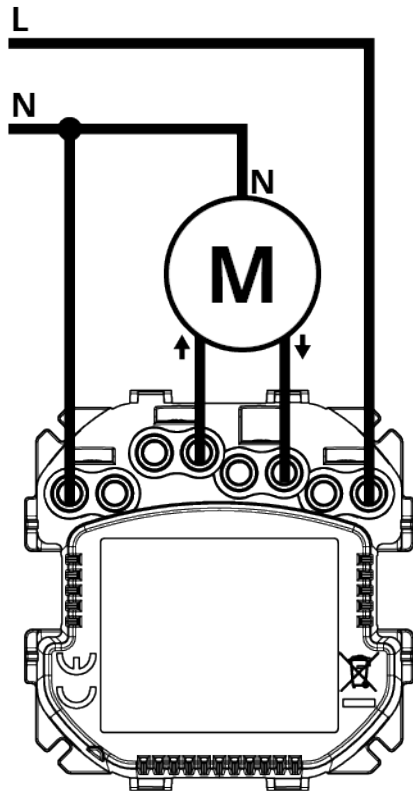

Figure 3: Example connection with roller blind motor

3. Verify correctness of connection.
4. Tighten the terminal screws using PH1 screwdriver.

3.4 - Assembling device

- When installing the device in the mounting box orient the device with terminal screws going up or to the left (for horizontal button position) to ensure button order.
- When installing with covers other than Nice, we recommend disabling the LED by changing parameter 13 to 0.

3.4.1 - Installation with Nice cover

1. Insert the device with mounting frame into the mounting box and secure with mounting claws and screws.
2. Snap the cover plate to the device.
3. Snap the switch button to the device.

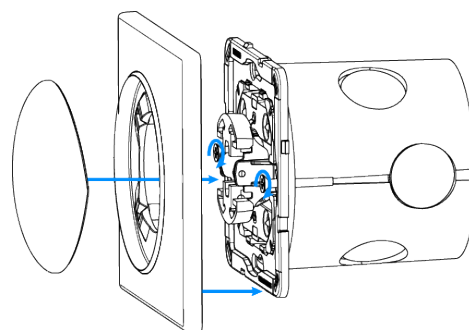

Figure 4: Installation with Nice cover

3.4.2 - Installation with G55 cover

1. Insert the device with mounting frame into the mounting box and secure with mounting claws and screws.
2. Snap the new cover plate to the device.
3. Snap the switch button adapter (sold separately) to the device.
4. Snap the new switch button to the device.

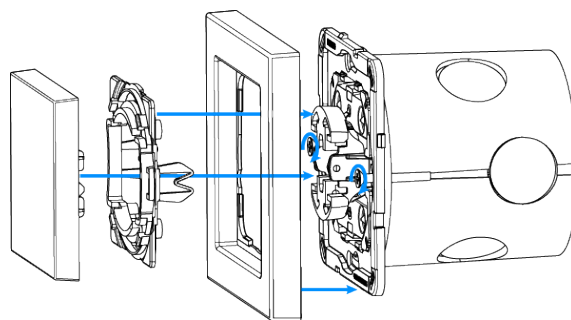

Figure 5: Installation with G55 cover

3.4.3 - Installation with LC cover

1. Insert the device with mounting frame (sold separately) into the mounting box and secure with mounting claws and screws.
2. Snap the switch button adapter (sold separately) to the device.
3. Snap the new inner cover plate to the device.
4. Snap the new outer cover plate to the device.
5. Snap the new switch button to the device.

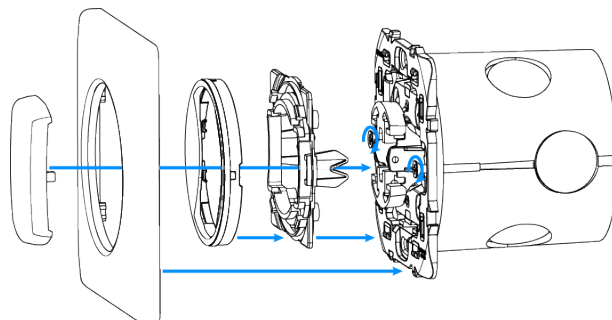

Figure 6: Installation with LC cover

3.4.4 - Installation with SO cover

1. Insert the device with mounting frame (sold separately) into the mounting box and secure with mounting claws and screws.
2. Snap the new cover plate to the device.
3. Snap the new switch button to the device.

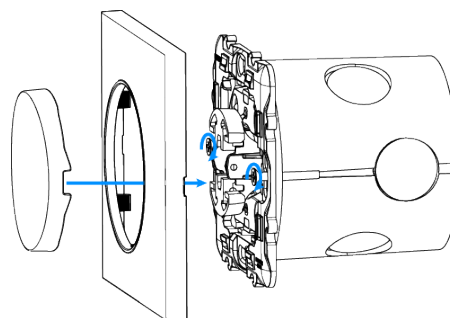

Figure 7: Installation with SO cover

3.5 - Activating device

1. If the device is fully assembled, switch on the mains voltage.
2. LED ring light means the device is powered and can be added to the Z-Wave network.

4 ADDING TO Z-WAVE NETWORK

Adding (Inclusion) – Z-Wave device learning mode, which enables adding the device to the existing Z-Wave network.

4.1 - Adding manually

1. Power the device.
2. Set the main hub in the (Security/non-Security Mode) add mode. For more information, see the hub manual.
3. Quickly, three times click one of the buttons.
4. If you are adding in Security S2 Authenticated, input the underlined part of the device security key (DSK), which is labeled on the bottom of the box.
5. LED starts blinking yellow, wait for the adding process to end.
6. Adding result is confirmed with the Z-Wave hub message and the LED frame:
 - **Green** – successful (non-secure, S0, S2 non-authenticated)
 - **Magenta** – successful (Security S2 Authenticated)
 - **Red** – not successful

4.2 - Adding using SmartStart

With the **SmartStart** function enabled products can be added into the Z-Wave network by scanning the Z-Wave QR Code present on the product with a hub providing the SmartStart inclusion. A SmartStart product is added automatically within 10 minutes of being switched on in the network range.

Note

To use the SmartStart function your hub needs to support Security S2. For more information, see the hub manual.

1. Enter the full DSK string code to your hub. If your hub is capable of QR scanning, scan the QR code placed on the label on the bottom of the box.
2. Power the device.
3. Wait for the adding process to start (up to a few minutes), which is signalled with yellow LED blinking.
4. Adding result is confirmed with the Z-Wave hub message and the LED frame:
 - **Green** – successful (non-secure, S0, S2 non-authenticated)
 - **Magenta** – successful (Security S2 Authenticated)
 - **Red** – not successful

Note

In case of problems with adding the device, reset the device and repeat the adding procedure.

5 REMOVING FROM Z-WAVE NETWORK

Removing (Exclusion) – Z-Wave device learning mode, which enables removing the device from the existing Z-Wave network. Removing also results in resetting the device to factory defaults.

1. Power the device.
2. Set the main hub in the remove mode. For more information, see the hub manual.
3. Quickly, three times click one of the buttons.
4. LED starts blinking yellow, wait for the removing process to end.
5. Successful removing is confirmed with the Z-Wave hub message and red LED colour.

Note

Removing device isn't possible if the central scene notifications have been activated with parameters 40 and 41.

6 CALIBRATION

Calibration is a process during which a device learns the position of the limit switches and a motor characteristic. Calibration is mandatory for the device to correctly recognize a roller blind position. The procedure consists of an automatic, full movement between the limit switches (up, down, and up again).

Button description:

- ▲ – the 1st button, for up movement
- ▼ – the 2nd button, for down movement

6.1 - Automatic positioning of standard roller blind using the menu

1. Set parameter 151 to 1 (default).
2. Quickly, three times click, press, and hold one of the buttons to enter the menu.
3. Release button when the device glows white.
4. Quickly click the button to confirm.
5. The device performs the calibration process, completing full cycle – up, down and up again. During the calibration the LED frame blinks white.
6. Test whether the positioning works correctly.

6.2 - Automatic positioning of standard roller blind using the parameters

1. Set parameter 151 to 1 (default).
2. Set parameter 150 to 2.
3. The device performs the calibration process, completing full cycle – up, down and up again. During the calibration the LED frame blinks white.
4. Test whether the positioning works correctly.

6.3 - Manual positioning of slats in the Venetian blinds mode

1. Set parameter 151 to 2.
2. Calibrate blinds as standard ones. For more information, see parts 6.1 and 6.2.

Note

By default, time of transition between extreme positions is set to 150 (1.5 seconds) with parameter 152.

3. Turn slats between extreme positions by holding ▲ or ▼ button:
 - if after full cycle a blind starts moving up or down - decrease value of parameter 152.
 - if after full cycle the slats doesn't reach end positions - increase value of parameter 152.
4. Repeat previous step until satisfactory positioning is achieved.
5. Test whether the positioning works correctly. Correctly configured slats shouldn't force the blinds to move up or down.

6.4 - Manual positioning of roller blind with built-in driver

1. Set parameter 151 to 5 or 6.
2. By default, time of transition between extreme positions is set to 6000 (60 seconds) in parameters 156 and 157.
3. Move roller blinds between extreme positions by clicking ▲ or ▼ switch:
 - if roller blind stops before reaching top - increase value of parameter 156.
 - if roller blind doesn't stop after reaching top - decrease value of parameter 156.
 - If roller blind stops before reaching bottom - increase value of parameter 157.
 - If roller blind doesn't stop after reaching bottom - decrease value of parameter 157.
4. Repeat previous step until satisfactory positioning is achieved.
5. Test whether the positioning works correctly.

7 OPERATING DEVICE

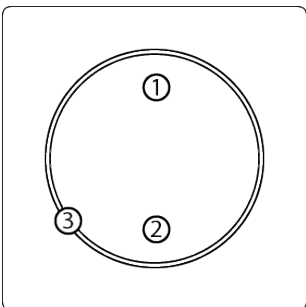

Notes for Figure 8

- 1 – the first/UP/▲ button
- 2 – the second/DOWN/▼ button
- 3 – LED ring

Figure 8: Controls

7.1 - Button control

Operating roller blinds (configured with parameter 24)

- Click ▲ to initiate up movement
- Click ▼ to initiate down movement

If the blind is moving, clicking any button, stops the movement.

Operating slats of venetian blinds

- Hold ▲ to initiate slats rotation up
- Hold ▼ to initiate slats rotation down

Release to stop the movement.

Other actions

- 3 x click – start learn mode to add/remove to/from the Z-Wave network
- 1, 2, 3 x click/hold/release – activate scene in the hub for specific action (requires prior configuration using parameters 40 and 41)
- 3 x click, then press, and hold – enter the menu

7.2 - Visual indications

The built-in LED light shows current device status.

| Action | Colour | Meaning |
|---------------------------|------------------|---|
| After powering the device | Green | Device added to a Z-Wave network (non-secure, S0, S2 non-authenticated) |
| | Magenta | Device added to a Z-Wave network (Security S2 Authenticated) |
| | Red | Device not added to a Z-Wave network |
| State of the device | White | Load turned ON (configurable with parameters 11 and 12) |
| Update | Blinking cyan | Update in progress |
| | Green | Update successful |
| | Red | Update not successful |
| Menu | Blinking green | Entering the menu (added as non-secure, S0, S2 non-authenticated) |
| | Blinking magenta | Entering the menu (added as Security S2 Authenticated) |
| | Blinking red | Entering the menu (not added to a Z-Wave network) |
| | White | Start calibration |
| | Green | Resetting energy consumption memory |
| | Yellow | Resetting to factory defaults |

7.3 - Menu

Menu enables performing the Z-Wave network actions.

To use the menu:

1. Quickly, three times click, then press and hold one of the buttons. The device blinks to signal adding status. For more information, see 7.2 - Visual indications.
2. Release the button when the device signals a desired position with colour:
 - **White** – start calibration
 - **Green** – reset energy consumption memory
 - **Yellow** – reset to factory defaults
3. Quickly click the button to confirm.

8 RESETTING TO FACTORY DEFAULTS

Reset procedure restoring the device back to its factory settings, which means all information about the Z-Wave hub and user configuration are deleted. Resetting to factory defaults doesn't reset energy consumption memory.

Note

Resetting the device isn't the recommended way of removing the device from the Z-Wave network. Use reset procedure only if the primary hub is missing or inoperable. Certain device removal can be achieved by the procedure of removing described.

1. Quickly, three times click, then press and hold one of the buttons to enter the menu.
2. Release the button when the device glows yellow.
3. Quickly click the button to confirm.
4. After a few seconds the device is restarted, which is signalled with red LED colour.

9 POWER AND ENERGY METERING

The device enables the active power and energy consumption monitoring. Data is sent to the main Z-Wave hub. Measuring is carried out by the most advanced microcontroller technology, assuring maximum accuracy and precision (+/- 1% for loads greater than 10 W).

Electric active power – power that energy receiver is changing into a work or a heat. The unit of active power is Watt [W].

Note

Power measurement can contain mains voltage fluctuations within +/- 10%.

Electric energy – energy consumed by a device through a time period. Consumers of electricity in households are billed by suppliers on the basis of active power used in given unit of time. Most commonly measured in kilowatt-hour [kWh]. One kilowatt-hour is equal to one kilowatt of power consumed over period of one hour, 1 kWh = 1000 Wh.

To reset consumption memory:

1. Quickly, three times click, then press and hold one of the buttons to enter the menu.
2. Release button when the device glows green.
3. Quickly click the button. Device blinks two times green to confirm.

Note

The device stores periodically the consumption data in the device memory. Disconnecting the module from the power supply doesn't erase stored energy consumption data.

10 ASSOCIATIONS

Association (linking devices) – direct control of other devices within the Z-Wave system network.

Associations enable:

- reporting the device status to the Z-Wave hub with Lifeline group.
- creating simple automations by controlling other devices without participation of the main hub using groups assigned to actions on the device.

Note

Commands send to the 2nd and 3rd association groups reflect button operation according to device configuration. For example, turning the first channel on using button sends frame responsible for the same action.

Table 4 - Walli Roll-Control - Association groups

| Association group | Name | Description |
|-------------------|----------------|---|
| 1 st | Lifeline | Reports the device status and enables assigning a single device, the hub by default. Only one node can be assigned. |
| 2 nd | Roller Shutter | Assigned to shutter position control – UP/DOWN, uses Switch Multilevel command class |
| 3 rd | Slats | Assigned to slats position control – UP/DOWN, uses Switch Multilevel command class |

Walli Roll-Control enables controlling five regular or multichannel devices per one association group with the exception of the **Lifeline** group, which is reserved solely for the hub and only one node can be assigned.

Table 5 - Walli Roll-Control - Association groups mapping

| Root | Endpoint | Association group in endpoint |
|---------------------|------------|-------------------------------|
| Association Group 2 | Endpoint 1 | Association Group 2 |
| Association Group 3 | Endpoint 2 | Association Group 2 |

Table 6 - Walli Roll-Control - Switch Multilevel commands sent to association groups

| Parameter settings | Button | Click | Hold | Release |
|---------------------------------|----------------|--|---|--|
| Parameter 151 set to 1, 5, or 6 | Button 1 and 2 | Start/Stop Level Change: the 2 nd group | Start Level Change: the 3 rd group | Stop Level Change: the 3 rd group |
| Parameter 151 set to 2 | Button 1 and 2 | Start/Stop Level Change: the 2 nd group | - | Set Level: the 3 rd group |

11 ADVANCED PARAMETERS

The device operation can be customized according to the user needs. The settings can be adjusted using Z-Wave hub to which the device is added. The way of adjusting them might differ depending on the hub.

In the Yubii Home interface parameters are presented as simple options in Advanced Settings of the device.

| Table 7 - Walli Roll-Control - Advanced parameters | | | | |
|--|---|---|---|----------------|
| Parameter | Description | Available setting | Default setting | Parameter size |
| 11. LED frame – colour when moving | Defines the LED colour when the motor is running | 0 – LED disabled 1 – white 2 – red 3 – green 4 – blue 5 – yellow 6 – cyan 7 – magenta | 1 (white) | 1 [byte] |
| 12. LED frame – colour when not moving | Defines the LED colour when the motor isn't running | | 0 (disabled) | 1 [byte] |
| 13. LED frame – brightness | Enables adjusting the LED frame brightness | 0 – LED disabled 1 – 100 (1 - 100% brightness) | 100 (100%) | 1 [byte] |
| 24. Buttons orientation | Enables reversing the operation of the buttons | 0 – default - the 1 st button UP, the 2 nd button DOWN 1 – reversed - the 1 st button DOWN, the 2 nd button UP | 0 | 1 [byte] |
| 25. Outputs orientation | Enables reversing the operation of Q1 and Q2 without changing the wiring, for example, in case of invalid connection. | 0 – default (Q1 - UP, Q2 - DOWN) 1 – reversed (Q1 - DOWN, Q2 - UP) | 0 | 1 [byte] |
| 30. Alarm configuration - 1st slot | Determines to which alarm frames and how the device should react. The parameters consist of 4 bytes, three most significant bytes are set according to the official the Z-Wave protocol specification. | <ul style="list-style-type: none"> • 1B [MSB] – Notification Type • 2B – Notification Status • 3B – Event/State Parameters • 4B [LSB] – action: <ul style="list-style-type: none"> 0x00 – no action on output 0xX1 – turn ON 0xX2 – turn OFF 0xX3 – turn ON/OFF continuously 0x0X – no action on LED frame 0x1X – LED frame blinks red 0x2X – LED frame blinks green 0x4X – LED frame blinks blue 0x8X – disable LED frame 0xFX – LED activate alarm sequence (red-white-blue) | [0x00, 0x00, 0x00, 0x00] (disabled) | 4 [bytes] |
| 31. Alarm configuration - 2nd slot | | | [0x05, 0xFF, 0x00, 0x00] (Water Alarm, any notification, no action) | |
| 32. Alarm configuration - 3rd slot | | | [0x01, 0xFF, 0x00, 0x00] (Smoke Alarm, any notification, no action) | |
| 33. Alarm configuration - 4th slot | | | [0x02, 0xFF, 0x00, 0x00] (CO Alarm, any notification, no action) | |
| 34. Alarm configuration - 5th slot | | | [0x04, 0xFF, 0x00, 0x00] (Heat Alarm, any notification, no action) | |
| 35. Alarm configuration – duration | Defines duration of alarm sequence. When time set using this parameter elapses, an alarm is cancelled, LED frame and relay restore normal operation, but don't recover state from before the alarm. | 0 – infinite 1 - 32400 (1 s - 9 h, 1 s step) – duration | 600 (10min) | 2 [byte] |
| 40. First button – scenes sent | Determines which actions result in sending scene IDs assigned to them. Values can be combined (e.g. 1+2=3 means that scenes for single and double click are sent). Enabling scenes for triple click disables entering the device in learn mode by triple clicking. | 1 – Key pressed 1 time 2 – Key pressed 2 times 4 – Key pressed 3 times 8 – Key hold down and key released | 0 (no scenes) | 1 [byte] |
| 41. Second button – scenes sent | | | | |
| 60. Power reports – include self-consumption | Determines whether the power measurements for Endpoint 1 should include power consumed by the device itself | 0 – Self-consumption not included 1 – Self-consumption included | 0 (not included) | 1 [byte] |
| 61. Power reports for first channel – on change | Defines minimal change (from the last reported) in measured power that results in sending new report. For loads under 50 W the parameter is irrelevant, report is sent every 5 W change. | 0 – reporting on change disabled 1 - 500 (1 - 500%, 1% step) – minimal change | 15 (15%) | 2 [bytes] |

Table 7 - Walli Roll-Control - Advanced parameters

| Parameter | Description | Available setting | Default setting | Parameter size |
|---|--|--|--------------------------|------------------|
| 62. Power reports for first channel – periodic | Defines reporting interval for measured power. Periodic reports are independent from changes in value (parameter 61). | 0 – periodic reports disabled 30 - 32400 (30 s - 9 h, 1 s step) – time interval | 3600 (1h) | 2 [bytes] |
| 65. Energy reports for first channel – on change | Defines minimal change (from the last reported) in measured energy that results in sending new report. | 0 – reporting on change disabled 1 - 500 (0.01 - 5 kWh, 0.01 kWh step) – minimal change | 10 (0.1 kWh) | 2 [bytes] |
| 66. Energy reports for first channel – periodic | Defines reporting interval for measured energy. Periodic reports are independent from changes in value (parameter 65). | 0 – periodic reports disabled 30 - 32400 (30 s - 9 h, 1 s step) – time interval | 3600 (1h) | 2 [bytes] |
| 150. Force calibration | By setting this parameter to 2 the device enters the calibration mode. The parameter relevant only if the device is set to work in positioning mode (parameter 151 set to 1 or 2). | 0 – device isn't calibrated 1 – device is calibrated 2 – force device calibration | 0 | 1 [byte] |
| 151. Operating mode | Enables adjusting operation according to the connected device | 1 – roller blind (with positioning) 2 – Venetian blind (with positioning) 5 – roller blind with built-in driver 6 – roller blind with built-in driver (impulse) | 1 | 1 [byte] |
| 152. Venetian blind – time of full turn of the slats | For Venetian blinds (parameter 151 set to 2) the parameter determines time of full turn cycle of the slats. The parameter is irrelevant for other modes. | 0 - 65535 (0 - 655.35 s, every 0.01 s) - time of turn | 150 (1.5 seconds) | 4 [bytes] |
| 153. Set slats back to previous position | For Venetian blinds (parameter 151 set to 2) the parameter determines slats positioning in various situations. The parameter is irrelevant for other modes. | 0 – slats return to previously set position only in case of the main hub operation 1 – slats return to previously set position in case of the main hub operation, momentary switch operation, or when the limit switch is reached 2 – slats return to previously set position in case of the main hub operation, momentary switch operation, when the limit switch is reached or after receiving the Switch Multilevel Stop control frame | 1 | 1 [byte] |
| 154. Delay motor stop after reaching end switch | Determines the time after which the motor is stopped after end switch contacts are closed. | 1 - 255 (0.1s - 25.5 seconds) | 10 (1 second) | 2 [bytes] |
| 155. Motor operation detection | Power threshold interpreted as reaching a limit switch. | 1 - 255 (1 - 255 W) - report interval 0 - no detection | 10 (10W) | 2 [bytes] |
| 156. Time of up movement | Determines the time needed for roller blinds to reach the top. For modes with positioning the value is set automatically during calibration, otherwise, it needs to be set manually. | 1 - 65535 (0.01 - 655.35 seconds) | 6000 (60 seconds) | 4 [bytes] |
| 157. Time of down movement | This parameter determines the time needed for roller blinds to reach the bottom. For modes with positioning the value is set automatically during calibration, otherwise, it needs to be set manually. | | | |

Endpoint 1:

Generic Device Class: GENERIC_TYPE_SWITCH_MULTILEVEL

Specific Device Class: SPECIFIC_TYPE_CLASS_B_MOTOR_CONTROL

Description: control up/down

Endpoint 2:

Generic Device Class: GENERIC_TYPE_SWITCH_MULTILEVEL

Specific Device Class: SPECIFIC_TYPE_CLASS_B_MOTOR_CONTROL

Description: control tilt.

Switch Multilevel Command Class values refers to:

- 0x00 - fully close
- 0x63 - fully open

Table 8 - Walli Roll-Control - Supported Command Classes

| No. | Command Class | Version | Secure |
|-----|--|---------|--------|
| 1. | COMMAND_CLASS_ZWAVEPLUS_INFO [0x5E] | V2 | |
| 2. | COMMAND_CLASS_SWITCH_MULTILEVEL [0x26] | V4 | YES |
| 3. | COMMAND_CLASS_ASSOCIATION [0x85] | V2 | YES |
| 4. | COMMAND_CLASS_MULTI_CHANNEL_ASSOCIATION [0x8E] | V3 | YES |
| 5. | COMMAND_CLASS_ASSOCIATION_GRP_INFO [0x59] | V2 | YES |
| 6. | COMMAND_CLASS_TRANSPORT_SERVICE [0x55] | V2 | |
| 7. | COMMAND_CLASS_VERSION [0x86] | V2 | YES |
| 8. | COMMAND_CLASS_MANUFACTURER_SPECIFIC [0x72] | V2 | YES |
| 9. | COMMAND_CLASS_DEVICE_RESET_LOCALLY [0x5A] | V1 | YES |
| 10. | COMMAND_CLASS_POWERLEVEL [0x73] | V1 | YES |
| 11. | COMMAND_CLASS_SECURITY [0x98] | V1 | |
| 12. | COMMAND_CLASS_SECURITY_2 [0x9F] | V1 | |
| 13. | COMMAND_CLASS_SUPERVISION [0x6C] | V1 | |
| 14. | COMMAND_CLASS_METER [0x32] | V3 | YES |
| 15. | COMMAND_CLASS_CONFIGURATION [0x70] | V1 | YES |
| 16. | COMMAND_CLASS_CRC_16_ENCAP [0x56] | V1 | |
| 17. | COMMAND_CLASS_NOTIFICATION [0x71] | V8 | YES |
| 18. | COMMAND_CLASS_PROTECTION [0x75] | V2 | YES |
| 19. | COMMAND_CLASS_MULTI_CHANNEL [0x60] | V4 | YES |
| 20. | COMMAND_CLASS_CENTRAL_SCENE [0x5B] | V3 | YES |
| 21. | COMMAND_CLASS_FIRMWARE_UPDATE_MD [0x7A] | V4 | YES |
| 22. | COMMAND_CLASS_APPLICATION_STATUS [0x22] | V1 | |
| 23. | COMMAND_CLASS_BASIC [0x20] | V1 | YES |

Table 9 - Walli Roll-Control - Multichannel Command Class

| No. | Command Class | Version | Secure |
|-------------------|--|---------|--------|
| Endpoint 1 | | | |
| 1. | COMMAND_CLASS_ZWAVEPLUS_INFO [0x5E] | V2 | |
| 2. | COMMAND_CLASS_SWITCH_MULTILEVEL [0x26] | V4 | YES |
| 3. | COMMAND_CLASS_ASSOCIATION [0x85] | V2 | YES |
| 4. | COMMAND_CLASS_MULTI_CHANNEL_ASSOCIATION [0x8E] | V3 | YES |
| 5. | COMMAND_CLASS_ASSOCIATION_GRP_INFO [0x59] | V2 | YES |
| 6. | COMMAND_CLASS_SECURITY [0x98] | V1 | |
| 7. | COMMAND_CLASS_SECURITY_2 [0x9F] | V1 | |
| 8. | COMMAND_CLASS_SUPERVISION [0x6C] | V1 | |
| 9. | COMMAND_CLASS_METER [0x32] | V3 | YES |
| 10. | COMMAND_CLASS_NOTIFICATION [0x71] | V8 | YES |
| 11. | COMMAND_CLASS_APPLICATION_STATUS [0x22] | V1 | |
| Endpoint 2 | | | |
| 12. | COMMAND_CLASS_ZWAVEPLUS_INFO [0x5E] | V2 | |
| 13. | COMMAND_CLASS_SWITCH_MULTILEVEL [0x26] | V4 | YES |
| 14. | COMMAND_CLASS_ASSOCIATION [0x85] | V2 | YES |
| 15. | COMMAND_CLASS_MULTI_CHANNEL_ASSOCIATION [0x8E] | V3 | YES |
| 16. | COMMAND_CLASS_ASSOCIATION_GRP_INFO [0x59] | V2 | YES |
| 17. | COMMAND_CLASS_SECURITY [0x98] | V1 | |
| 18. | COMMAND_CLASS_SECURITY_2 [0x9F] | V1 | |
| 19. | COMMAND_CLASS_SUPERVISION [0x6C] | V1 | |
| 20. | COMMAND_CLASS_METER [0x32] | V3 | YES |
| 21. | COMMAND_CLASS_APPLICATION_STATUS [0x22] | V1 | |

The device uses Notification Command Class to report different events to the hub (“Lifeline” group).

Table 10 - Walli Roll-Control - Notification Command Class

| Notification Type | Event | Parameter | Status | In endpoints |
|-------------------------|---|---------------------------------|--------------------------------|------------------|
| Power Management [0x08] | Over-current detected [0x06/V3] | | 0xFF – enable (non-changeable) | Root, Endpoint 1 |
| System [0x09] | System hardware failure with manufacturer proprietary failure code [0x03] | MP code: 0x01 [device overheat] | 0xFF – enable (non-changeable) | Root, Endpoint 1 |

Protection Command Class enables preventing local or remote control of the outputs.

Table 11 - Walli Roll-Control - Protection Command Class

| Type | State | Description | Hint |
|-------|-------|---|--|
| Local | 0 | Unprotected - The device isn't protected, and may be operated normally with the user interface. | Inputs connected with outputs. |
| Local | 2 | No operation possible – button cannot change relay state, any other functionality is available (menu). | Inputs disconnected from outputs. |
| RF | 0 | Unprotected - The device accept and respond to all RF Commands. | Outputs can be controlled with Z-Wave. |
| RF | 1 | No RF control – command class basic and switch binary are rejected, every other command class is handled. | Outputs can't be controlled with Z-Wave. |

Table 12 - Walli Roll-Control - Meter Command Class

| Meter Type | Scale | Rate Type | Precision | Size |
|-----------------|-------------------------------|---------------|-----------|------|
| Electric [0x01] | Electric_kWh [0x00] (default) | Import [0x01] | 2 | 4 |
| Electric [0x01] | Electric_W [0x02] | Import [0x01] | 1 | 2 |

13 PARTS COMPATIBILITY

Table 13 - Walli Roll-Control - Available Nice parts

| Name | Symbol | Included in Walli Roll-Control |
|---------------------------------------|---------------------|--------------------------------|
| Walli Roller Shutter Unit | FG-WREU111-AS-8001 | x |
| Switch Button Adapter | FG-WDSEU221-PP-0007 | |
| Mounting Frame NICE/G55 | FG-Wx-AS-4001 | x |
| Mounting Frame LC | FG-Wx-AS-4002 | |
| Mounting Frame SO | FG-Wx-AS-4003 | |
| Switch Button with Lightguide (white) | FG-WDSEU221-AS-8100 | x |
| Single Cover Plate (white) | FG-Wx-PP-0001 | x |
| Double Cover Plate (white) | FG-Wx-PP-0003 | |
| Triple Cover Plate (white) | FG-Wx-PP-0004 | |

Table 14 - Walli Roll-Control - Required Nice parts for G55 (only with non-metalised outer surface: Standard 55, E2, Event, Event Clear) covers

| Name | Symbol |
|---------------------------|---------------------|
| Walli Roller Shutter Unit | FG-WREU111-AS-8001 |
| Switch Button Adapter | FG-WDSEU221-PP-0007 |
| Mounting Frame NICE/G55 | FG-Wx-AS-4001 |

Table 15 - Walli Roll-Control - Required Nice parts for LC selected covers

| Name | Symbol |
|---------------------------|---------------------|
| Walli Roller Shutter Unit | FG-WREU111-AS-8001 |
| Switch Button Adapter | FG-WDSEU221-PP-0007 |
| Mounting Frame LC | FG-Wx-AS-4002 |

Table 16 - Walli Roll-Control - Required Nice parts for SO selected covers

| Name | Symbol |
|---------------------------|--------------------|
| Walli Roller Shutter Unit | FG-WREU111-AS-8001 |
| Mounting Frame SO | FG-Wx-AS-4003 |

14 PRODUCT DISPOSAL

This product is an integral part of the automation and therefore must be disposed together with the latter. At the end of the product lifetime, the disassembly and scrapping operations must be performed by qualified personnel.

This product is made of various types of material, some of which can be recycled while others must be scrapped. Seek information on the recycling and disposal systems envisaged by the local regulations in your area for this product category.



As indicated by the symbol alongside, disposal of this product in domestic waste is strictly prohibited. Separate the waste into categories for disposal, according to the methods envisaged by current legislation in your area, or return the product to the retailer when purchasing a new version.

⚠ CAUTION!

- Some parts of the product may contain pollutant or hazardous substances which, if disposed of into the environment, may cause serious damage to the environment or physical health.
- Local legislation may envisage serious fines in the event of abusive disposal of this product.

15 DECLARATION OF CONFORMITY

Hereby, Nice S.p.A., declares that the radio equipment type Walli Roll-Control is in compliance with Directive 2014/53/EU. The full text of the EU Declaration of Conformity is available at: <http://www.niceforyou.com/en/support>.



Nice SpA
Oderzo TV Italia
info@niceforyou.com

www.niceforyou.com