

User Guide

Models:

FA-EZ-14-50

FA-EZ-10-50

Input/Output: 230VAC 40A 60Hz

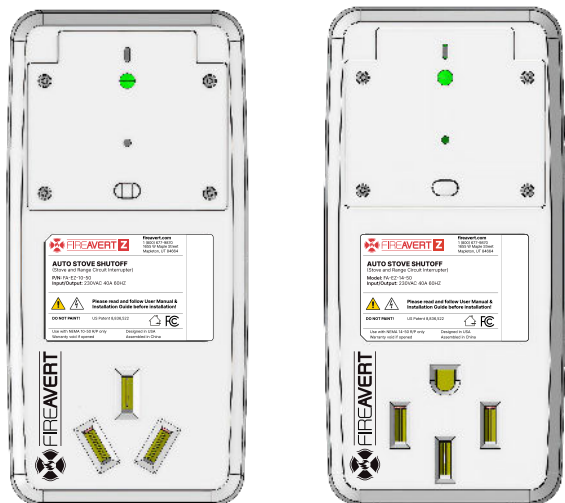

FA-EZ-10-50
(3 Prong)

FA-EZ-14-50
(4 Prong)

FireAvert helps protect homes from the leading cause of home fires in the United States - unattended cooking- by automatically disconnecting power to the range or stove in the event that smoke is detected. FireAvert devices activate in response to the audible signal of the existing smoke alarms using a patented audio recognition feature. FireAvert can be installed in less than 10 minutes in a few easy steps and without tools or professional assistance.

ATTENTION! TO ENSURE YOUR SAFETY WHILE INSTALLING AND USING THE FIREAVERT DEVICE, YOU MUST READ AND FOLLOW ALL INSTRUCTIONS OUTLINED IN THIS USER MANUAL.

WARNING!: The FireAvert shutoff device is not intended to replace the user's own responsibility and good judgment in preventing fires. The FireAvert aids in preventing accidental unattended cooking fires in the kitchen.

Orientation

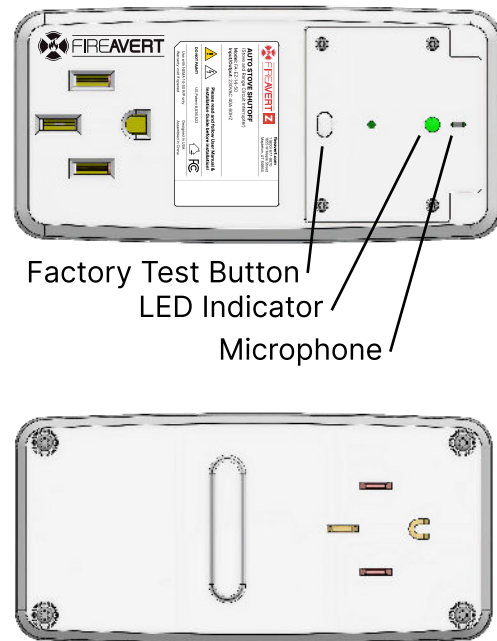

FireAvert Plug - (male blades)

General Safety & Warnings

Read ALL instructions BEFORE attempting to install any FireAvert device.

Failure to follow all instructions and warnings may result in damage to the FireAvert device(s) or the appliance(s), and may cause loss of property, bodily injury or death.

NEVER attempt to install a FireAvert device that appears damaged or broken. If the device appears damaged or broken, please contact customer service for assistance.

NEVER attempt to force the FireAvert male blades or receptacle connections, when installing plugs.

NEVER attempt to modify, alter, or adapt any part of the FireAvert for use other than outlined in this user guide. These FireAvert models are designed for use with NEMA 10-50 (3 Prong) and NEMA 14-50 (4 Prong) respectively.

DO NOT attempt to open the FireAvert, it contains no user-serviceable components. Attempting to open or disassemble the FireAvert voids the warranty and may render the FireAvert inoperable.

DANGER, HIGH VOLTAGE! When working with electrical devices, basic precautions should always be followed to prevent fire, injury, or death.

FireAvert is only intended to be installed and used in an environment with temperatures between 40°F- 100°F (4.4°C-37.8°C), humidity less than 80% and not excessively dusty. Dust build-up, excessive heat, or humidity may cause malfunction. [NFPA 72 § 29.83.4(29.8.2.4(2))]

DO NOT attempt to install or remove the FireAvert unit while the outlet is powered ON. The circuit breaker that powers the outlet must be switched OFF before installation or removal of the FireAvert.

DO NOT pinch or squeeze the FireAvert device between the stove and the wall outlet after installation is complete.

DO NOT use the FireAvert without completing a user verification test. Please see step 6 of the installation instructions.

The FireAvert should be tested monthly with household smoke alarms. When checking the FireAvert follow the same instructions as used in the initial verification test. Please see step 6 of the installation instructions.

If the FireAvert device enters protection mode (in the case of a smoke event) and disconnects power to the appliance, follow the instructions for rebooting the device found in this manual. **DO NOT** attempt to reboot the device in any other way.

In the event that a new smoke alarm OR range/stove is installed in the home, the FireAvert device must be retested for proper function. See **Step 6** in the installation instructions for details.

Approved Smoke Alarms

The FireAvert is designed to work with any modern RESIDENTIAL (NRTL listed) smoke alarm typically found in retail stores that has a frequency around 3.2kHz. [Disclaimer: FireAvert has not been evaluated to work with low frequency (520Hz) alarms.] If for any reason the smoke alarm does not properly communicate to the FireAvert and shut off the appliance, please consider purchasing a newer smoke alarm.

The fire-warning equipment listed herein, known generally by industry designation as a "smoke alarm accessory", has been evaluated and found to be compliant for performance and operation when installed in accordance with the installation requirements for smoke alarms at a radial distance of 20 ft (6.1m) along a horizontal flow path from a stationary or fixed cooking appliance. [NFPA 72 § 29]

Approved Extension Cable

If the FireAvert does not fit properly behind the stove, it may require a pigtail extension cable.

Please visit fireavert.com to purchase:
model # PT-10-50 (3 Prong Pigtail)
or
model # PT-14-50 (4 Prong Pigtail)
depending on the plug type.

FireAvert is the only authorized retailer of this designated extension cable.

Note: FireAvert's ability to recognize a smoke alarm may be compromised by loud music, background noise, or if the smoke alarm is too far from the stove/range.



Scan the QR code for
product specifications

Installation Steps

1. Switch OFF the circuit breaker to the range/stove. Test the appliance for power to verify that the correct breaker has been switched OFF.

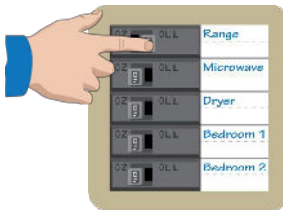

2. Move the range/stove away from the wall to provide access to the power outlet and unplug the appliance by gently rocking the plug up and down, and from side to side while withdrawing the plug. Ensure that the correct FireAvert model corresponds to the exposed outlet and plug.

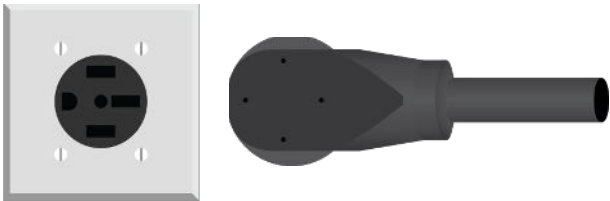

3. Install the FireAvert device. Insert the range/stove plug into the receptacle on the FireAvert. Line up the male blades on the back of the FireAvert with the power outlet on the wall. Use both hands to insert the FireAvert firmly into the wall outlet until the FireAvert sits completely flush against the outlet face.



4. Push the range back against the wall. THE RANGE/STOVE MUST BE PUSHED BACK AGAINST THE WALL AND THE ANTI-TIP BRACKET SECURED BEFORE ATTEMPTING TO TURN ON THE CIRCUIT BREAKER. Failing to do so may result in a faulty user test.

5. Switch ON the circuit breaker to the range/stove. After installation, the FireAvert device automatically enters listening mode as indicated by a solid GREEN LED.

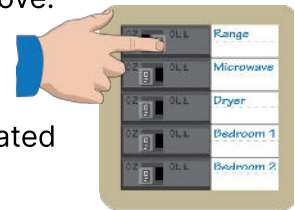

6. IMPORTANT-Perform a user verification test. Heat a pot of water on the range/stove, then press and hold the test button on the smoke alarm for approximately 1 minute until the FireAvert turns the power OFF to the stove/range. If installed correctly, FireAvert will cut power to the range/stove within 10-40 seconds. **PLEASE USE EAR PROTECTION!** Smoke alarms are loud and can damage hearing.

Pairing with Z-Wave® Systems

The FireAvert device can be operated in any Z-Wave® network with other Z-Wave® certified devices from other manufacturers. All mains operated nodes within the network will act as repeaters regardless of vendor to increase reliability of the network. This multichannel device is composed of a notification end point, and a binary switch end point.

Application Status Command Class
This device will reject commands to reinstate power to the end appliance when the safety interlock is engaged.

Basic Command Class
This product supports the Basic Command Class using the binary switch ON/OFF feature set. This command enables power ON/OFF to the stove. This supports Security Level 2.

Notification Command Classes (v3) - are supported using the notification report. The three notification types are 1.) Stove Power 2.) Smoke Alarm Listener, and 3.) Safety Interlock. This class supports Security Level 2.

Association Command Class (v3) - groups include 1.) Lifeline
All groups support up to 5 devices per group. This class supports Security Level 2.

Lifeline: All notifications and unsolicited reports from the device are sent via the Lifeline association group.

Appliance Power: Allows visibility to the appliance state

Identify Function- This product can be identified using the Indicator Command Class with the Indicator ID 0x50 (identify). When the identify Indicator Command Class is sent to the FireAvert device, the LED will flash.

SmartStart Inclusion/Exclusion- Enables this product to be added into a Z-Wave® network by scanning the Z-Wave® QR Code present on the product faceplate with a smart phone, or controller providing SmartStart inclusion. The product will be added automatically within 10 minutes of being switched on in the network vicinity.

Classic Inclusion
1. Ensure that the device is plugged in and powered ON, indicated by a Green LED.
2. Press the test button for 5-10 seconds. The LED will begin blinking with a Green LED.

Classic Exclusion
Press and hold the test button for 5-10 seconds. The LED will flash when unpaired.
* NOTE: The device will remain on the network for up to 30 seconds after it has been excluded.

Security
This product supports Z-Wave® Command Class Security, Level 2.

RESET THE RADIO
Press and hold the test button for 10-12 seconds. The device will reset all Z-Wave® settings and leave the network. Please use this procedure only when the network primary controller is missing or otherwise inoperable.

Factory Reset
Press and hold the test button for at least 10 seconds to factory reset the device.

Installation is now complete!

Proceed to Operating Instructions, “Rebooting the FireAvert”.

Test

It is highly recommended to perform a user verification test for the FireAvert device(s) at the same time that smoke alarms are tested monthly. Refer to **step 6** for the testing procedure.

Operating Instructions

FireAvert Protection Mode- FireAvert devices constantly monitor the surrounding area for the sound of a smoke alarm. The FireAvert device has a 20 second delay built in from the time the smoke alarm begins sounding until the device enters Protection Mode and disconnects power to the range/stove. For the FireAvert device to enter Protection Mode, the end appliance must draw a minimum of 1.5A while the smoke alarm is sounding.

When the FireAvert device activates and enters Protection Mode, it automatically disconnects power to the range/stove and the LED indicator on the FireAvert will change to solid RED.

Rebooting the FireAvert Device- In the event that the FireAvert device enters Protection Mode and cuts power to your appliance, the FireAvert device must be rebooted before it can be used further. To reboot the FireAvert device, simply switch OFF the circuit breaker to the range/stove for 10 seconds, then switch it back ON again. The reboot is successful when power is restored to the range/stove after the circuit breaker has been turned ON. Or reboot the device remotely using any software platform linked with the FireAvert Z-Wave® device.

New Smoke Alarms- if a new smoke alarm or range/stove is installed in the home or building where FireAvert device is installed, the FireAvert device(s) will need to be tested for proper function with the newly installed smoke alarm/appliance. Please refer to step 6 in the installation instructions.